

# Stock Timing Pulleys

## STOCK TIMING PULLEYS

1/5" - 7/8" PITCH  
QD — TAPER BUSHED  
AND STOCK BORE



Stock Bore



Taper Bushed



QD

| PITCH IN. | PULLEY DESIGNATION |
|-----------|--------------------|
| 1/5"      | XL (Extra Light)   |
| 3/8"      | L (Light)          |
| 1/2"      | H (Heavy)          |
| 7/8"      | XH (Extra Heavy)   |

*Martin* Timing Pulleys are manufactured to extremely close specifications and are stocked in minimum plain bore, Taper Bushed and Q.D. bushed styles depending on size and pitch.

See tables for stock pulley types. Bushings are priced separately and must be added to pulley price.

Illustrations below indicate stock pulley construction type listed in tables.

Type DF

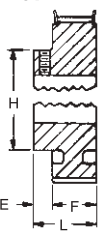

Type D

Type CF

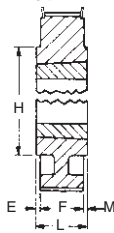

Type C

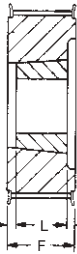

Type KF

Type AF

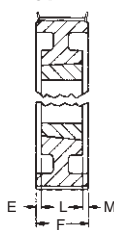

Type A

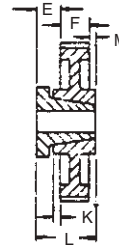

Type G

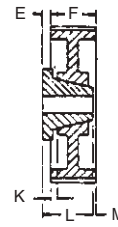

Type H

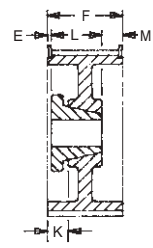

Type J

"F" designation in pulley type means pulley is flanged. When drive center distance is eight times the diameter of the smaller pulley or when drive is operating on vertical shafts, both pulleys should be flanged.

### DEFINITION OF CATALOG NUMBERS

EX: TB 20L100

TB — Requires Taper Bushing

20 — Number of Teeth

L — 3/8" Pitch (Light)

100 — Belt Width 1"

EX: 72L100SD

72 — Number of Teeth

L — 3/8" Pitch (Light)

100 — Belt Width 1"

SD — Requires QD Bushing

EX: 16L100

Min. Plain Bore

### Pulley Style Designation As Shown in Tables

Dash 1 = Block Body Style

Dash 2 = Web Style

Dash 3 = Arm/Spoke Style

Size XXH (1/4" Pitch).

Available as made-to-order.

Call your nearest *Martin* facility.

Pulley sizes shown stocked as stock bore only: max. bore listed is without keyway. If keyway is used reduce max. bore by twice keyway depth.

Let us quote your made-to-order and large quantity requirements.

Timing belts and pulleys — in order to handle a wide range of loads, speeds and applications at highest possible efficiencies — are made in five stock pitches. Circular pitch (usually referred to as pitch) is a basic consideration in the selection of timing pulleys as with gear and chain drives. Pitch is the distance between groove centers and is measured on the pulley pitch circle. On the belt, pitch is the distance between tooth centers and is measured on the pitch line of the belt.

The pitch line of the belt is located within the tension member and coincides with the pitch circle of the pulley mating with it. Any timing belt must be run with pulleys of the same pitch. A belt of one pitch cannot be used successfully with pulleys of a different pitch.

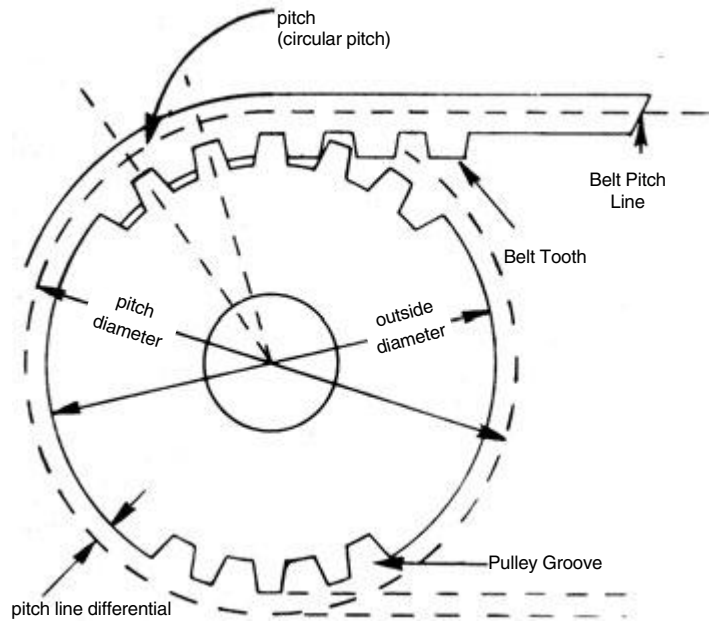

### TIMING BELT TERMINOLOGY

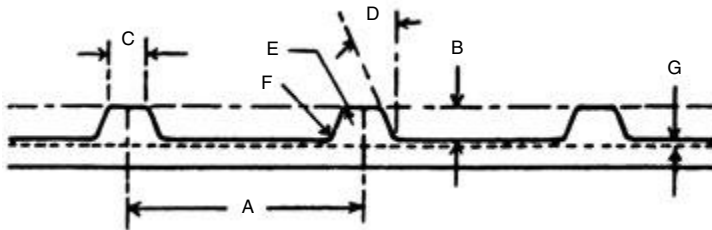

- A Pitch of Teeth
  - B Depth of Teeth
  - C Width at Bottom of Teeth
  - D Pressure Angle
  - E Radius at Bottom of Teeth
  - F Radius at Top of Teeth
  - G Pitch Line Differential
- Belt P.L. = "A" X Total No. of Teeth in Belt

### TIMING PULLEY TERMINOLOGY

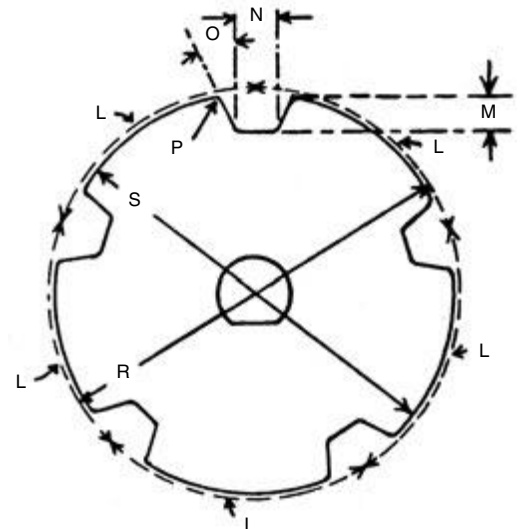

- L Circular Pitch of Groove
- M Minimum Depth of Groove, Including Clearance
- N Width of Groove at Minimum Depth, Including Clearance
- O Pressure Angle
- P Top Radius of Groove
- R Pitch Diameter (Always > S)
- S Outside Diameter

# Timing Pulley Terminology



## Timing Pulleys

Timing pulleys have evenly spaced axial grooves cut in their periphery to make correct, positive engagement with the mating teeth of the belt. These pulleys are designed so that the teeth of the belt enter and leave the grooves with negligible friction. All pulleys, stock and made-to-order, have minimum tooth-to-groove clearance (backlash). The pulley's pitch diameter will always be greater than its outside diameter. Pulleys are available in a wide range of stock widths and diameters.

## Minimum Pulley Diameters

| pitch              | speed rpm | recommended minimum* | no. of grooves |
|--------------------|-----------|----------------------|----------------|
|                    |           | pitch diam. in.      |                |
| 1/5 in.<br>(XL)    | 3500      | .764                 | 12 XL          |
|                    | 1750      | .637                 | 10 XL          |
|                    | 1160      | .637                 | 10 XL          |
| 3/8 in.<br>(L)     | 3500      | 1.910                | 16 L           |
|                    | 1750      | 1.671                | 14 L           |
|                    | 1160      | 1.432                | 12 L           |
| 1/2 in.<br>(H)     | 3500      | 3.183                | 20 H           |
|                    | 1750      | 2.865                | 18 H           |
|                    | 1160      | 2.546                | 16 H           |
| 7/8 in.<br>(XH)    | 1750      | 7.242                | 26 XH          |
|                    | 1160      | 6.685                | 24 XH          |
|                    | 870       | 6.127                | 22 XH          |
| 1 1/4 in.<br>(XXH) | 1750      | 10.345               | 26 XXH         |
|                    | 1160      | 9.549                | 24 XXH         |
|                    | 870       | 8.754                | 22 XXH         |

\*Smaller diameter pulleys can be used if a corresponding reduction in belt service life is satisfactory.

## Flanged Pulleys

Because timing belts have an inherent, gentle side thrust, it is necessary to use at least one flanged pulley to prevent the belt from riding off. Generally, for economy, the smaller pulley in each drive is flanged. However, when the center distance is greater than eight times the diameter of the smaller pulley on drive ratios less than 3 to 1, or when the drive is operated on other than horizontal shafts — both pulleys should be flanged. When a drive has three pulleys, at least two should be flanged. If the drive has more than three pulleys, every other pulley should be flanged.

## Pulley Diameters

Stock timing belts should not be used over pulley diameters less than those recommended above without expecting some reduction in belt life. This reduced belt life is the result of flex fatigue of the steel tension members in the belt. If pulleys smaller than recommended must be used, the use of special timing belts should be considered.



# Stock Timing Pulleys

# XL 1/5" Pitch

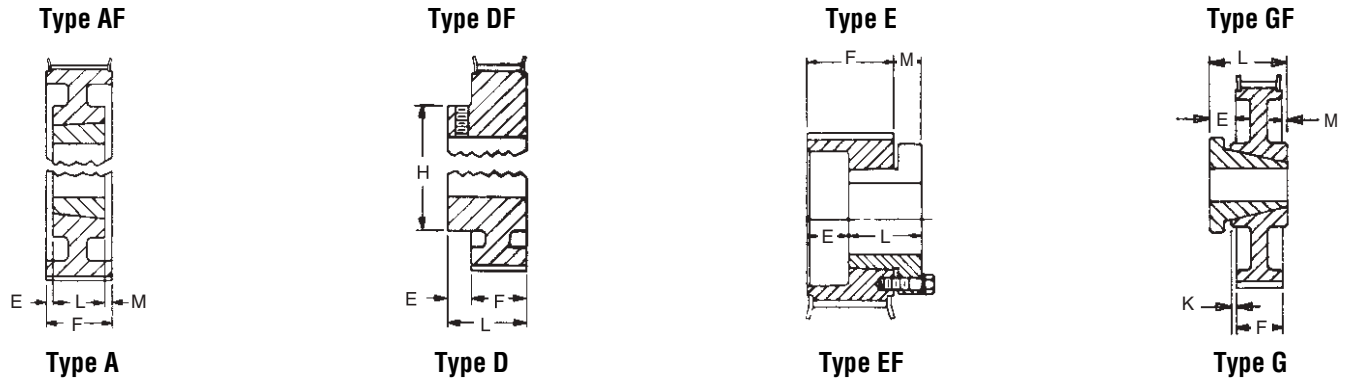

Dash 1 = Solid Style      Dash 2 = Web Style      Dash 3 = Arm/Spoke Style  
 "F" type description indicates flanged.

## XL - 1/5" Pitch

XL 037 For Belts 1/4" and 3/8" Wide  
 Minimum Plain Bore

F = 1/16

| No. Teeth | Part Number | Pitch Diameter | Max FL O.D. | Type | Bore |        | E    | H      | L     | WT   |
|-----------|-------------|----------------|-------------|------|------|--------|------|--------|-------|------|
|           |             |                |             |      | Stk. | Max.   |      |        |       |      |
| 10        | 10XL037     | 0.637          | 0.929       | DF-1 | 3/16 | 1/4    | 7/32 | 7/16   | 25/32 | 0.03 |
| 11        | 11XL037     | 0.700          | 0.929       | DF-1 | 3/16 | 1/4    | 7/32 | 7/16   | 25/32 | 0.04 |
| 12        | 12XL037     | 0.764          | 0.993       | DF-1 | 3/16 | 5/16   | 7/32 | 1/2    | 25/32 | 0.06 |
| 14        | 14XL037     | 0.891          | 1.120       | DF-1 | 1/4  | 3/8    | 7/32 | 9/16   | 25/32 | 0.08 |
| 15        | 15XL037     | 0.955          | 1.184       | DF-1 | 1/4  | 7/16   | 7/32 | 5/8    | 25/32 | 0.09 |
| 16        | 16XL037     | 1.019          | 1.248       | DF-1 | 1/4  | 1/2    | 7/32 | 11/16  | 25/32 | 0.10 |
| 18        | 18XL037     | 1.146          | 1.375       | DF-1 | 1/4  | 9/16   | 7/32 | 13/16  | 25/32 | 0.13 |
| 20        | 20XL037     | 1.273          | 1.502       | DF-1 | 1/4  | 11/16  | 5/16 | 15/16  | 7/8   | 0.18 |
| 21        | 21XL037     | 1.337          | 1.566       | DF-1 | 1/4  | 11/16  | 5/16 | 15/16  | 7/8   | 0.19 |
| 22        | 22XL037     | 1.401          | 1.630       | DF-1 | 1/4  | 3/4    | 5/16 | 1      | 7/8   | 0.22 |
| 24        | 24XL037     | 1.528          | 1.756       | DF-1 | 1/4  | 13/16  | 5/16 | 1 1/16 | 7/8   | 0.25 |
| 28        | 28XL037     | 1.783          | 2.011       | DF-1 | 1/4  | 15/16  | 5/16 | 1 1/16 | 7/8   | 0.34 |
| 30        | 30XL037     | 1.910          | 2.138       | DF-1 | 5/16 | 1 1/16 | 5/16 | 1 1/8  | 7/8   | 0.41 |
| 32        | 32XL037     | 2.037          | —           | D-1  | 5/16 | 1 1/8  | 7/16 | 1 1/2  | 1     | 0.25 |
| 36        | 36XL037     | 2.292          | —           | D-1  | 5/16 | 1 3/8  | 7/16 | 1 1/2  | 1     | 0.29 |
| 40        | 40XL037     | 2.546          | —           | D-1  | 5/16 | 1 3/8  | 7/16 | 1 1/2  | 1     | 0.35 |
| 42        | 42XL037     | 2.674          | —           | D-1  | 5/16 | 1 3/8  | 7/16 | 1 1/2  | 1     | 0.31 |
| 44        | 44XL037     | 2.801          | —           | D-1  | 5/16 | 1 3/8  | 7/16 | 1 1/2  | 1     | 0.34 |
| 48        | 48XL037     | 3.056          | —           | D-1  | 5/16 | 1 3/8  | 7/16 | 1 1/2  | 1     | 0.63 |
| 60        | 60XL037     | 3.820          | —           | D-1  | 3/8  | 1 3/8  | 7/16 | 1 1/2  | 1     | 0.90 |
| 72        | 72XL037     | 4.584          | —           | D-1  | 3/8  | 1 3/8  | 7/16 | 1 1/2  | 1     | 0.50 |

Note: XL Pulleys stocked min. plain bore with 2 setscrews @ 90°. If keyway is used, reduce max. bore by twice keyway depth.  
 Pulley O.D. = P.D. - .02"

# L 3/8" Pitch

# Stock Timing Pulleys

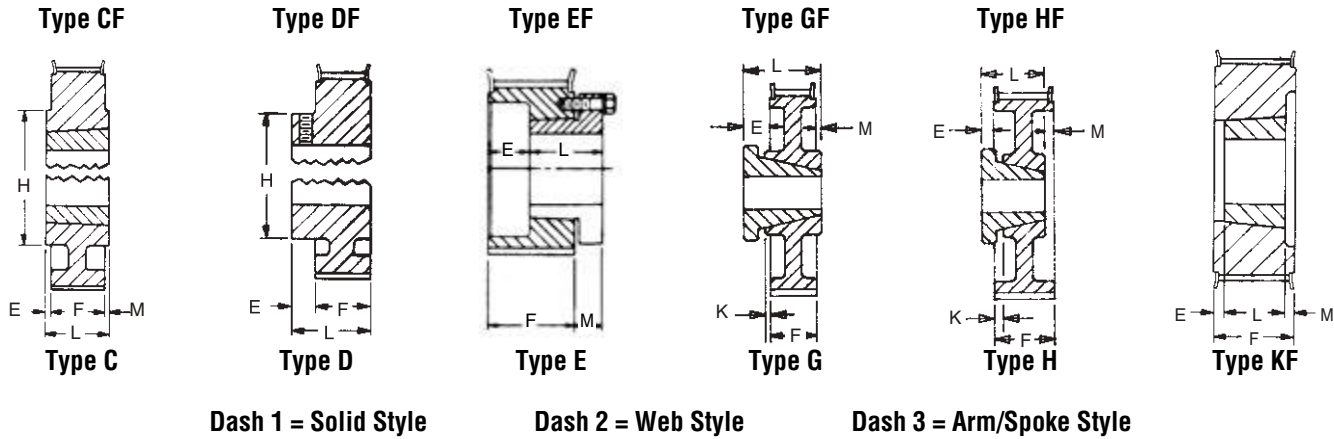

## L - 3/8" Pitch

L050 For Belts 1/2" Wide

Minimum Plain Bore

F = 3/4

| No. Teeth | Part Number | Pitch Diameter | Max FL O.D. | Type | Bore |        | Dimensions |         |        | Wt.  |
|-----------|-------------|----------------|-------------|------|------|--------|------------|---------|--------|------|
|           |             |                |             |      | Stk. | Max.   | E          | H       | L      |      |
| 10        | 10L050      | 1.194          | 1 1/16      | DF-1 | 3/8  | 3/16   | 3/8        | 1 3/16  | 1 1/8  | 0.28 |
| 12        | 12L050      | 1.432          | 1 4/64      | DF-1 | 3/8  | 3/16   | 1/2        | 1 1/16  | 1 1/4  | 0.30 |
| 13        | 13L050      | 1.552          | 1 3/4       | DF-1 | 3/8  | 3/16   | 1/2        | 1 1/8   | 1 1/4  | 0.35 |
| 14        | 14L050      | 1.671          | 1 59/64     | DF-1 | 3/8  | 7/8    | 1/2        | 1 1/8   | 1 1/4  | 0.40 |
| 15        | 15L050      | 1.790          | 2           | DF-1 | 1/2  | 3/16   | 1/2        | 1 1/8   | 1 1/4  | 0.50 |
| 16        | 16L050      | 1.910          | 2 3/32      | DF-1 | 1/2  | 1 1/8  | 5/8        | 1 7/16  | 1 3/8  | 0.60 |
| 17        | 17L050      | 2.029          | 2 1/32      | DF-1 | 1/2  | 1 1/8  | 5/8        | 1 1/2   | 1 3/8  | 0.65 |
| 18        | 18L050      | 2.149          | 2 25/64     | DF-1 | 1/2  | 1 3/16 | 5/8        | 1 5/8   | 1 3/8  | 0.75 |
| 19        | 19L050      | 2.268          | 2 3/8       | DF-1 | 1/2  | 1 3/16 | 5/8        | 1 5/8   | 1 3/8  | 0.80 |
| 20        | 20L050      | 2.387          | 2 5/8       | DF-1 | 1/2  | 1 1/4  | 5/8        | 1 11/16 | 1 3/8  | 0.94 |
| 21        | 21L050      | 2.507          | 2 3/4       | DF-1 | 1/2  | 1 3/16 | 11/16      | 1 7/8   | 1 7/16 | 1.00 |
| 22        | 22L050      | 2.626          | 2 7/8       | DF-1 | 1/2  | 1 1/2  | 3/4        | 2       | 1 1/2  | 1.10 |
| 24        | 24L050      | 2.865          | 3 1/64      | DF-1 | 1/2  | 1 5/8  | 3/4        | 2 1/4   | 1 1/2  | 1.60 |
| 26        | 26L050      | 3.104          | 3 11/32     | DF-1 | 1/2  | 1 5/8  | 3/4        | 2 1/2   | 1 1/2  | 2.30 |
| 28        | 28L050      | 3.342          | 3 31/64     | DF-1 | 1/2  | 1 5/8  | 3/4        | 2 3/4   | 1 1/2  | 2.50 |
| 30        | 30L050      | 3.581          | 3 59/64     | DF-1 | 1/2  | 1 5/8  | 3/4        | 2 3/8   | 1 1/2  | 2.70 |
| 32        | 32L050      | 3.820          | 4 1/16      | DF-1 | 1/2  | 1 5/8  | 7/8        | 3 1/16  | 1 5/8  | 3.00 |

L Pulleys 10 - 16 teeth min. plain bore stocked with 1 set screw. If keyway is used, reduced max. bore by twice keyway depth.  
Dimensions in inches. Weight in pounds  
Pulley O.D. = P.D. - .03"

## L - 3/8" Pitch

L050 For Belts 1/2" Wide (3/8" Pitch)

QD Type

F = 3/4

| No. Teeth | Part Number | Pitch Diameter | Max FL O.D. | Type   | Bush | Bore Range  | Dimensions |     |         |     | Wt. Less Bush. |
|-----------|-------------|----------------|-------------|--------|------|-------------|------------|-----|---------|-----|----------------|
|           |             |                |             |        |      |             | E          | K   | L       | M   |                |
| 18        | 18L050JA    | 2.149          | 2 25/64     | EF-1*  | JA   | 1/2-1 1/4   | 3/16       | —   | 1 1/16  | 1/2 | 0.40           |
| 20        | 20L050JA    | 2.387          | 2 3/8       | EF-1*  | JA   | 1/2-1 1/4   | 3/16       | —   | 1 1/16  | 1/2 | 0.50           |
| 22        | 22L050JA    | 2.626          | 2 7/8       | EF-1*  | JA   | 1/2-1 1/4   | 3/16       | —   | 1 1/16  | 1/2 | 0.70           |
| 24        | 24L050SH    | 2.865          | 3 1/64      | GF-1 + | SH   | 1/2-1 11/16 | 3/16       | —   | 1 3/16  | 0   | 0.70           |
| 26        | 26L050SH    | 3.104          | 3 11/32     | GF-1 + | SH   | 1/2-1 11/16 | 3/16       | 0   | 1 3/16  | 0   | 1.00           |
| 28        | 28L050SH    | 3.342          | 3 31/64     | GF-1 + | SH   | 1/2-1 11/16 | 3/16       | 0   | 1 3/16  | 0   | 1.10           |
| 30        | 30L050SDS   | 3.581          | 3 59/64     | GF-1   | SDS  | 1/2-2       | 3/8        | 0   | 1 3/8   | 0   | 1.10           |
| 32        | 32L050SDS   | 3.820          | 4 1/16      | GF-1   | SDS  | 1/2-2       | 3/8        | 0   | 1 3/8   | 0   | 1.40           |
| 36        | 36L050SDS   | 4.297          | 4 17/32     | GF-1   | SDS  | 1/2-2       | 3/8        | 0   | 1 3/8   | 0   | 2.00           |
| 40        | 40L050SDS   | 4.775          | 5 1/64      | GF-1   | SDS  | 1/2-2       | 3/8        | 0   | 1 3/8   | 0   | 2.80           |
| 44        | 44L050SDS   | 5.252          | 5 31/64     | GF-1   | SDS  | 1/2-2       | 3/8        | 0   | 1 3/8   | 0   | 3.60           |
| 48        | 48L050SDS   | 5.730          | 6 1/64      | GF-1   | SDS  | 1/2-2       | 3/8        | 0   | 1 3/8   | 0   | 4.40           |
| 60        | 60L050SD    | 7.162          | —           | G-3    | SD   | 1/2-2       | 7/8        | 1/4 | 1 19/16 | 1/4 | 4.20           |
| 72        | 72L050SD    | 8.594          | —           | G-3    | SD   | 1/2-2       | 7/8        | 1/4 | 1 3/16  | 1/4 | 6.60           |
| 84        | 84L050SD    | 10.027         | —           | G-3    | SD   | 1/2-2       | 7/8        | 1/4 | 1 19/16 | 1/4 | 5.80           |

Dimensions in inches. Weight in pounds  
Pulley O.D. = P.D. - .03"  
\*Reverse mount drilled only  
+Bushing Projects 1/16 on Small End.

**L050 Taper Bushed  
on Page K7**



# Stock Timing Pulleys

**L**  
**3/8" Pitch**

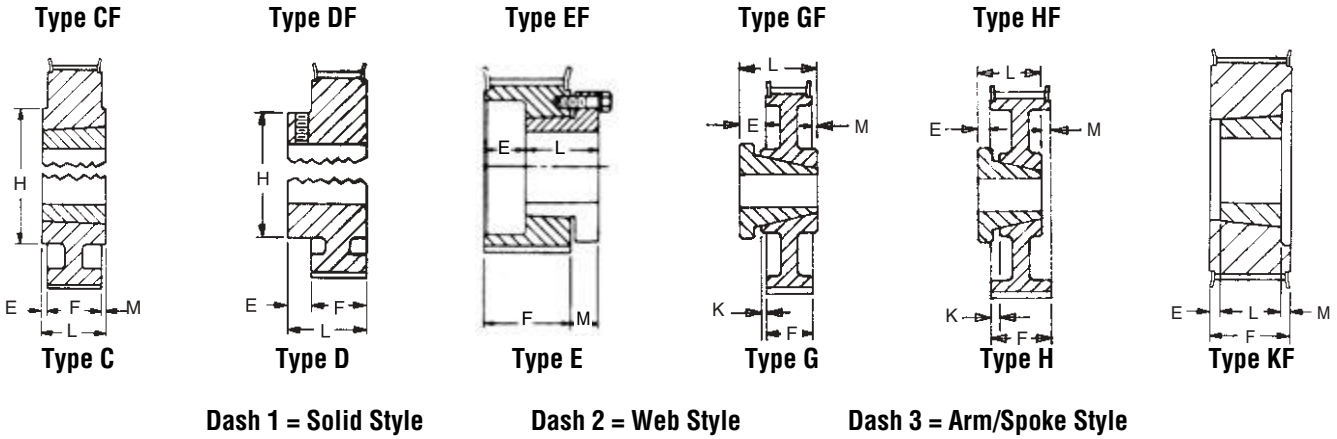

## L - 3/8" Pitch

L050 For Belts 1/2" Wide (3/8" Pitch)

Taper Bushed Type

F = 3/4

| No. Teeth | Part Number | Pitch Diameter | Max FL O.D.                     | Type | Bush | Bore Range | Dimensions |         |       |     | Wt. Less Bush. |
|-----------|-------------|----------------|---------------------------------|------|------|------------|------------|---------|-------|-----|----------------|
|           |             |                |                                 |      |      |            | E          | H       | L     | M   |                |
| 18        | TB18L050    | 2.149          | 2 <sup>25</sup> / <sub>64</sub> | CF-1 | 1008 | 1/2-1      | 3/8        | 1 1/8   | 7/8   | —   | 0.45           |
| 20        | TB20L050    | 2.387          | 2 5/8                           | CF-1 | 1008 | 1/2-1      | 3/8        | 1 11/16 | 7/8   | —   | 0.68           |
| 22        | TB22L050    | 2.626          | 2 7/8                           | CF-1 | 1008 | 1/2-1      | 3/8        | 2       | 7/8   | —   | 0.90           |
| 24        | TB24L050    | 2.865          | 3 1/64                          | CF-1 | 1210 | 1/2-1 1/4  | 1/2        | 2 1/4   | 1     | —   | 1.00           |
| 26        | TB26L050    | 3.104          | 3 11/32                         | CF-1 | 1210 | 1/2-1 1/4  | 1/2        | 2 1/2   | 1     | —   | 1.20           |
| 28        | TB28L050    | 3.342          | 3 37/64                         | CF-1 | 1610 | 1/2-1 1/4  | 1/2        | 2 3/4   | 1     | —   | 1.40           |
| 30        | TB30L050    | 3.581          | 3 83/64                         | CF-1 | 1610 | 1/2-1 3/8  | 1/2        | 2 7/8   | 1     | —   | 1.50           |
| 32        | TB32L050    | 3.820          | 4 1/16                          | CF-1 | 1610 | 1/2-1 3/8  | 1/2        | 3 1/8   | 1     | —   | 1.90           |
| 40        | TB40L050    | 4.775          | 5 1/64                          | CF-1 | 2012 | 1/2-2      | 1/2        | 3 11/16 | 1 1/4 | —   | 2.40           |
| 48        | TB48L050    | 5.730          | 6 3/64                          | CF-1 | 2012 | 1/2-2      | 1/2        | 3 11/16 | 1 1/4 | —   | 3.20           |
| 60        | TB60L050    | 7.162          | —                               | C-2  | 2012 | 1/2-2      | 1/2        | 4 3/8   | 1 1/4 | 1/4 | 4.90           |

Dimensions in inches. Weight in pounds  
Pulley O.D. = P.D. - .03"

## L - 3/8" Pitch

L075 For Belts 3/4" Wide (3/8" Pitch)

Minimum Plain Bore

F = 1

| No. Teeth | Part Number | Pitch Diameter | Max FL O.D. | Type | Bore |        | Dimensions |         |       | Wt.  |
|-----------|-------------|----------------|-------------|------|------|--------|------------|---------|-------|------|
|           |             |                |             |      | Stk. | Max.   | E          | H       | L     |      |
| 12        | 12L075      | 1.432          | 1 43/64     | DF-1 | 3/8  | 19/16  | 1/2        | 1 1/16  | 1 1/2 | 0.40 |
| 14        | 14L075      | 1.671          | 1 89/64     | DF-1 | 3/8  | 7/8    | 1/2        | 1 1/8   | 1 1/2 | 0.50 |
| 16        | 16L075      | 1.910          | 2 5/32      | DF-1 | 1/2  | 1 1/8  | 5/8        | 1 1/16  | 1 5/8 | 0.70 |
| 18        | 18L075      | 2.149          | 2 25/64     | DF-1 | 1/2  | 1 3/16 | 5/8        | 1 3/8   | 1 5/8 | 0.90 |
| 20        | 20L075      | 2.387          | 2 7/8       | DF-1 | 1/2  | 1 1/4  | 5/8        | 1 11/16 | 1 5/8 | 1.50 |
| 22        | 22L075      | 2.626          | 2 7/8       | DF-1 | 5/8  | 1 1/2  | 3/4        | 2       | 1 3/4 | 1.80 |
| 24        | 24L075      | 2.865          | 3 1/64      | DF-1 | 5/8  | 1 5/8  | 3/4        | 2 1/4   | 1 3/4 | 2.10 |
| 26        | 26L075      | 3.104          | 3 11/32     | DF-1 | 5/8  | 1 5/8  | 7/8        | 2 1/2   | 1 5/8 | 2.80 |
| 28        | 28L075      | 3.342          | 3 37/64     | DF-1 | 5/8  | 1 5/8  | 1          | 2 3/4   | 2     | 3.10 |
| 30        | 30L075      | 3.581          | 3 83/64     | DF-1 | 5/8  | 1 5/8  | 1          | 2 7/8   | 2     | 3.40 |
| 32        | 32L075      | 3.820          | 4 1/16      | DF-1 | 5/8  | 1 5/8  | 1          | 3 1/16  | 2     | 3.70 |

Dimensions in inches. Weight in pounds.  
Pulley O.D. = P.D. - .03"

L Pulleys 12 - 16 teeth min. plain bore stocked with 1-SS. If keyway is used, reduce max. bore by twice keyway depth.

# L 3/8" Pitch

## Stock Timing Pulleys

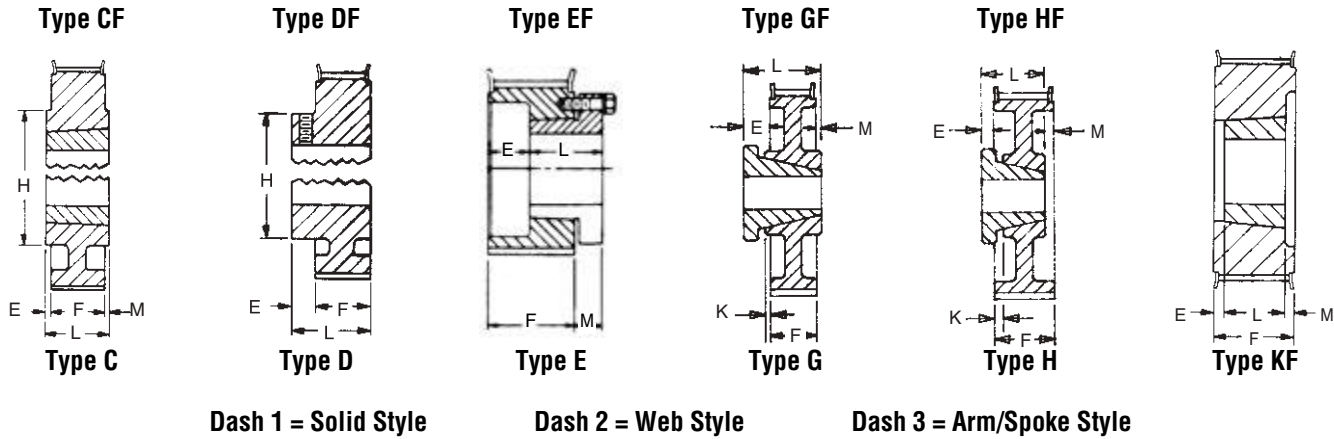

### L - 3/8" Pitch

L075 For Belts 3/4" Wide (3/8" Pitch)

QD Type

F = 1

| No. Teeth | Part Number | Pitch Diameter | Max FL O.D.                     | Type  | Bush | Bore Range   | Dimensions |     |        |      | Wt. Less Bush. |
|-----------|-------------|----------------|---------------------------------|-------|------|--------------|------------|-----|--------|------|----------------|
|           |             |                |                                 |       |      |              | E          | K   | L      | M    |                |
| 18        | 18L075JA    | 2.149          | 2 <sup>25</sup> / <sub>64</sub> | EF-1* | JA   | 1/2 - 1/4    | 3/16       | —   | 1 1/16 | 1/2  | 0.50           |
| 20        | 20L075JA    | 2.387          | 2 <sup>5</sup> / <sub>16</sub>  | EF-1* | JA   | 1/2 - 1/4    | 3/16       | —   | 1 1/16 | 1/2  | 0.70           |
| 22        | 22L075JA    | 2.626          | 2 <sup>7</sup> / <sub>16</sub>  | EF-1* | JA   | 1/2 - 1/4    | 3/16       | —   | 1 1/16 | 1/2  | 0.80           |
| 24        | 24L075SH    | 2.865          | 3 <sup>3</sup> / <sub>64</sub>  | EF-1* | SH   | 1/2 - 1 1/16 | 3/16       | —   | 1 1/16 | 5/16 | 0.80           |
| 26        | 26L075SH    | 3.104          | 3 <sup>11</sup> / <sub>32</sub> | EF-1* | SH   | 1/2 - 1 1/16 | 3/16       | —   | 1 1/16 | 5/16 | 1.10           |
| 28        | 28L075SH    | 3.342          | 3 <sup>37</sup> / <sub>64</sub> | EF-1* | SH   | 1/2 - 1 1/16 | 3/16       | —   | 1 1/16 | 5/16 | 1.30           |
| 30        | 30L075SDS   | 3.581          | 3 <sup>53</sup> / <sub>64</sub> | EF-1* | SDS  | 1/2 - 2      | 1/4        | —   | 1 3/8  | 5/8  | 1.50           |
| 32        | 32L075SDS   | 3.820          | 4 <sup>1</sup> / <sub>16</sub>  | EF-1* | SDS  | 1/2 - 2      | 1/4        | —   | 1 3/8  | 5/8  | 1.70           |
| 36        | 36L075SDS   | 4.297          | 4 <sup>17</sup> / <sub>32</sub> | HF-1  | SDS  | 1/2 - 2      | 3/8        | 1/4 | 1 3/8  | 0    | 2.30           |
| 40        | 40L075SDS   | 4.775          | 5 <sup>3</sup> / <sub>64</sub>  | HF-1  | SDS  | 1/2 - 2      | 3/8        | 1/4 | 1 3/8  | 0    | 3.10           |
| 44        | 44L075SDS   | 5.252          | 5 <sup>31</sup> / <sub>64</sub> | HF-1  | SDS  | 1/2 - 2      | 3/8        | 1/4 | 1 3/8  | 0    | 4.00           |
| 48        | 48L075SDS   | 5.730          | 6 <sup>3</sup> / <sub>64</sub>  | HF-1  | SDS  | 1/2 - 2      | 3/8        | 1/4 | 1 3/8  | 0    | 4.60           |
| 60        | 60L075SD    | 7.162          | —                               | G-3   | SD   | 1/2 - 2      | 1 1/16     | 1/8 | 1 3/16 | 1/8  | 4.70           |
| 72        | 72L075SD    | 8.594          | —                               | G-3   | SD   | 1/2 - 2      | 1 1/16     | 1/8 | 1 3/16 | 1/8  | 6.50           |
| 84        | 84L075SD    | 10.027         | —                               | G-3   | SD   | 1/2 - 2      | 1 1/16     | 1/8 | 1 3/16 | 1/8  | 6.30           |

Dimensions in inches. Weight in pounds

Pulley O.D. = P.D. - .03"

\*Reverse mount only

### L - 3/8" Pitch

L075 For Belts 3/4" Wide (3/8" Pitch)

Taper Bushed Type

F = 1

| No. Teeth | Part Number | Pitch Diameter | Max FL O.D.                      | Type | Bush | Bore Range    | Dimensions |                                  |         |     | Wt. Less Bush. |
|-----------|-------------|----------------|----------------------------------|------|------|---------------|------------|----------------------------------|---------|-----|----------------|
|           |             |                |                                  |      |      |               | E          | H                                | L       | M   |                |
| 18        | TB18L075    | 2.149          | 2 <sup>-25</sup> / <sub>64</sub> | KF-1 | 1008 | 1/2 - 1       | 1/8        | —                                | 7/8     | —   | 0.50           |
| 20        | TB20L075    | 2.387          | 2 <sup>-5</sup> / <sub>16</sub>  | KF-1 | 1008 | 1/2 - 1       | 1/8        | —                                | 7/8     | —   | 0.70           |
| 22        | TB22L075    | 2.626          | 2 <sup>-7</sup> / <sub>16</sub>  | KF-1 | 1008 | 1/2 - 1       | 1/8        | —                                | 7/8     | —   | 1.10           |
| 24        | TB24L075    | 2.865          | 3 <sup>-7</sup> / <sub>64</sub>  | KF-1 | 1210 | 1/2 - 1 - 1/4 | —          | —                                | 1       | —   | 0.90           |
| 26        | TB26L075    | 3.104          | 3 <sup>-11</sup> / <sub>32</sub> | KF-1 | 1210 | 1/2 - 1 - 1/4 | —          | —                                | 1       | —   | 1.30           |
| 28        | TB28L075    | 3.342          | 3 <sup>-37</sup> / <sub>64</sub> | KF-1 | 1610 | 1/2 - 1 - 5/8 | —          | —                                | 1       | —   | 1.30           |
| 30        | TB30L075    | 3.581          | 3 <sup>-53</sup> / <sub>64</sub> | KF-1 | 1610 | 1/2 - 1 - 5/8 | —          | —                                | 1       | —   | 1.60           |
| 32        | TB32L075    | 3.820          | 4 <sup>-1</sup> / <sub>16</sub>  | KF-1 | 1610 | 1/2 - 1 - 5/8 | —          | —                                | 1       | —   | 1.80           |
| 40        | TB40L075    | 4.775          | 5 <sup>-1</sup> / <sub>64</sub>  | CF-1 | 2012 | 1/2 - 2       | 1/4        | 3 <sup>-15</sup> / <sub>16</sub> | 1 - 1/4 | —   | 3.60           |
| 48        | TB48L075    | 5.730          | 6 <sup>-1</sup> / <sub>64</sub>  | CF-1 | 2012 | 1/2 - 2       | 1/4        | 3 <sup>-15</sup> / <sub>16</sub> | 1 - 1/4 | —   | 5.40           |
| 60        | TB60L075    | 7.162          | —                                | C-1  | 2012 | 1/2 - 2       | 1/8        | 4 <sup>-3</sup> / <sub>8</sub>   | 1 - 1/4 | 1/8 | 7.90           |

Dimensions in inches. Weight in pounds

Pulley O.D. = P.D. - .03"



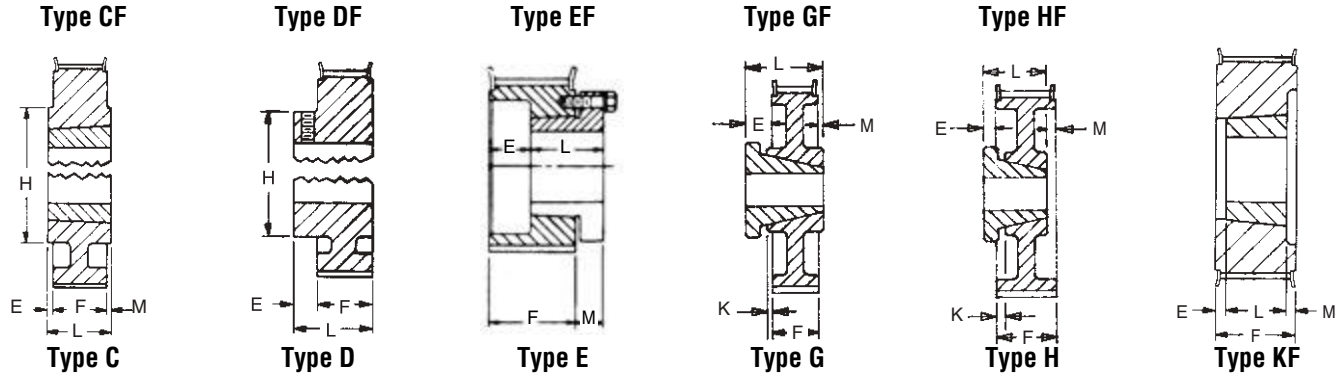

Dash 1 = Solid Style

Dash 2 = Web Style

Dash 3 = Arm/Spoke Style

### L - 3/8" Pitch

L100 For Belts 1" Wide (3/8" Pitch)

Minimum Plain Bore

F = 1 1/4

| No. Teeth | Part Number | Pitch Diameter | Max FL O.D.        | Type | Bore |        | Dimensions |        |       | Wt.  |
|-----------|-------------|----------------|--------------------|------|------|--------|------------|--------|-------|------|
|           |             |                |                    |      | Stk. | Max.   | E          | H      | L     |      |
| 14        | 14L100      | 1.671          | 1 <sup>59/64</sup> | DF-1 | 3/8  | 7/8    | 1/2        | 1 1/8  | 1 3/4 | 0.60 |
| 16        | 16L100      | 1.910          | 2 <sup>5/32</sup>  | DF-1 | 1/2  | 1 1/8  | 5/8        | 1 7/16 | 1 7/8 | 0.80 |
| 17        | 17L100      | 2.029          | 2 <sup>9/32</sup>  | DF-1 | 1/2  | 1 1/8  | 5/8        | 1 7/16 | 1 7/8 | 1.00 |
| 18        | 18L100      | 2.149          | 2 <sup>25/64</sup> | DF-1 | 1/2  | 1 3/16 | 5/8        | 1 7/8  | 1 7/8 | 1.10 |
| 19        | 19L100      | 2.268          | 2 3/8              | DF-1 | 1/2  | 1 3/16 | 5/8        | 1 7/8  | 1 7/8 | 1.40 |
| 20        | 20L100      | 2.387          | 2 3/8              | DF-1 | 1/2  | 1 3/16 | 5/8        | 1 7/8  | 1 7/8 | 1.75 |
| 21        | 21L100      | 2.507          | 2 3/4              | DF-1 | 5/8  | 1 9/16 | 1 1/16     | 1 7/8  | 1 7/8 | 1.80 |
| 22        | 22L100      | 2.626          | 2 7/8              | DF-1 | 5/8  | 1 1/2  | 3/4        | 2      | 2     | 2.00 |
| 24        | 24L100      | 2.865          | 3 <sup>3/64</sup>  | DF-1 | 5/8  | 1 8/16 | 3/4        | 2 1/4  | 2     | 2.50 |
| 26        | 26L100      | 3.104          | 3 <sup>11/32</sup> | DF-1 | 5/8  | 1 7/8  | 7/8        | 2 1/2  | 2 1/2 | 3.30 |
| 28        | 28L100      | 3.342          | 3 <sup>37/64</sup> | DF-1 | 5/8  | 1 7/8  | 1          | 2 3/4  | 2 1/4 | 3.60 |
| 30        | 30L100      | 3.581          | 3 <sup>39/64</sup> | DF-1 | 5/8  | 1 7/8  | 1          | 2 5/8  | 2 1/4 | 4.00 |
| 32        | 32L100      | 3.820          | 4 <sup>1/16</sup>  | DF-1 | 5/8  | 1 7/8  | 1          | 3 1/16 | 2 1/4 | 4.40 |

Dimensions in inches. Weight in pounds

Pulley O.D. = P.D. - .03"

L Pulleys 14 - 16 teeth min. plain bore stocked with 1-S.S. If keyway is used, reduce max. bore by twice keyway depth.

### L - 3/8" Pitch

L100 For Belts 1" Wide (3/8" Pitch)

QD Type

F = 1 1/4

| No. Teeth | Part Number | Pitch Diameter | Max FL O.D.        | Type  | Bush | Bore Range   | Dimensions |     |         |      | Wt. Less Bush. |
|-----------|-------------|----------------|--------------------|-------|------|--------------|------------|-----|---------|------|----------------|
|           |             |                |                    |       |      |              | E          | K   | L       | M    |                |
| 18        | 18L100JA    | 2.149          | 2 <sup>25/64</sup> | EF-1* | JA   | 1/2 - 1 1/4  | 1 1/16     | —   | 1 1/16  | 1/2  | 0.70           |
| 20        | 20L100JA    | 2.387          | 2 3/8              | EF-1* | JA   | 1/2 - 1 1/4  | 1 1/16     | —   | 1 1/16  | 1/2  | 0.90           |
| 22        | 22L100JA    | 2.626          | 2 7/8              | EF-1* | JA   | 1/2 - 1 1/4  | 1 1/16     | —   | 1 1/16  | 1/2  | 1.00           |
| 24        | 24L100SH    | 2.865          | 3 <sup>3/64</sup>  | EF-1* | SH   | 1/2 - 1 1/16 | 7/16       | —   | 1 1/16  | 5/16 | 1.00           |
| 26        | 26L100SH    | 3.104          | 3 <sup>11/32</sup> | EF-1* | SH   | 1/2 - 1 1/16 | 7/16       | —   | 1 1/16  | 5/16 | 1.30           |
| 28        | 28L100SH    | 3.342          | 3 <sup>37/64</sup> | EF-1* | SH   | 1/2 - 1 1/16 | 7/16       | —   | 1 1/16  | 5/16 | 1.70           |
| 30        | 30L100SDS   | 3.581          | 3 <sup>39/64</sup> | EF-1* | SDS  | 1/2 - 2      | 1/2        | —   | 1 1/8   | 5/8  | 2.00           |
| 32        | 32L100SDS   | 3.820          | 4 <sup>1/16</sup>  | EF-1* | SDS  | 1/2 - 2      | 1/2        | —   | 1 1/8   | 5/8  | 2.10           |
| 36        | 36L100SDS   | 4.297          | 4 <sup>17/32</sup> | HF-1  | SDS  | 1/2 - 2      | 1/8        | 1/2 | 1 3/8   | 0    | 2.60           |
| 40        | 40L100SDS   | 4.775          | 5 <sup>5/64</sup>  | HF-1  | SDS  | 1/2 - 2      | 1/8        | 1/2 | 1 3/8   | 0    | 3.40           |
| 44        | 44L100SDS   | 5.252          | 5 <sup>39/64</sup> | HF-1  | SDS  | 1/2 - 2      | 1/8        | 1/2 | 1 3/8   | 0    | 4.20           |
| 48        | 48L100SDS   | 5.730          | 6 <sup>1/64</sup>  | HF-1  | SDS  | 1/2 - 2      | 1/8        | 1/2 | 1 3/8   | 0    | 5.10           |
| 60        | 60L100SD    | 7.162          | —                  | G-3   | SD   | 1/2 - 2      | 5/8        | 0   | 1 13/16 | 0    | 6.00           |
| 72        | 72L100SD    | 8.594          | —                  | G-3   | SD   | 1/2 - 2      | 5/8        | 0   | 1 13/16 | 0    | 8.00           |
| 84        | 84L100SD    | 10.027         | —                  | G-3   | SD   | 1/2 - 2      | 5/8        | 0   | 1 13/16 | 0    | 9.20           |

Dimensions in inches. Weight in pounds

Pulley O.D. = P.D. - .03"

\*Reverse mount only



# L 3/8" Pitch

## Stock Timing Pulleys

Type CF

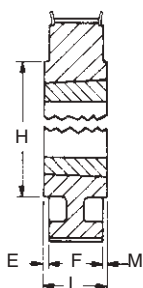

Type C

Type DF

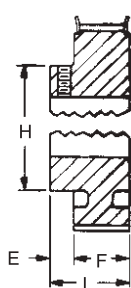

Type D

Type EF

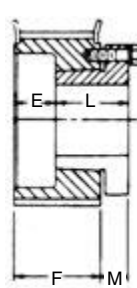

Type E

Type GF

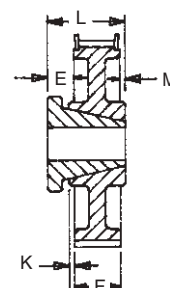

Type G

Dash 1 = Solid Style

Dash 2 = Web Style

Dash 3 = Arm/Spoke Style

“F” in type description indicates flanged.

Type HF

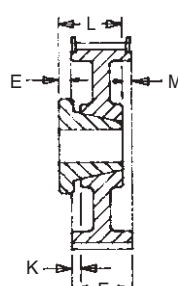

Type H

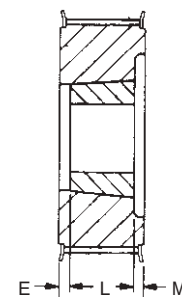

Type KF

### L - 3/8" Pitch

L100 For Belts 1" Wide (3/8" Pitch)

Taper Bushed Type

F = 1 1/4

| No. Teeth | Part Number | Pitch Diameter | Max FL. O.D.                    | Type | Bush | Bore Range  | Dimensions |   |       |   | Wt. Less Bush. |
|-----------|-------------|----------------|---------------------------------|------|------|-------------|------------|---|-------|---|----------------|
|           |             |                |                                 |      |      |             | E          | K | L     | M |                |
| 18        | TB18L100    | 2.149          | 2 <sup>29</sup> / <sub>64</sub> | KF-1 | 1008 | 1/2 - 1     | 3/8        | — | 7/8   | — | 0.70           |
| 20        | TB20L100    | 2.387          | 2 <sup>5</sup> / <sub>8</sub>   | KF-1 | 1008 | 1/2 - 1     | 3/8        | — | 7/8   | — | 1.00           |
| 22        | TB22L100    | 2.626          | 2 <sup>1</sup> / <sub>8</sub>   | KF-1 | 1008 | 1/2 - 1     | 3/8        | — | 7/8   | — | 1.30           |
| 24        | TB24L100    | 2.865          | 3 <sup>3</sup> / <sub>64</sub>  | KF-1 | 1210 | 1/2 - 1 1/4 | 1/4        | — | 1     | — | 1.30           |
| 26        | TB26L100    | 3.104          | 3 <sup>11</sup> / <sub>32</sub> | KF-1 | 1210 | 1/2 - 1 1/4 | 1/4        | — | 1     | — | 1.70           |
| 28        | TB28L100    | 3.342          | 3 <sup>3</sup> / <sub>64</sub>  | KF-1 | 1610 | 1/2 - 1 1/8 | 1/4        | — | 1     | — | 1.70           |
| 30        | TB30L100    | 3.581          | 3 <sup>59</sup> / <sub>64</sub> | KF-1 | 1610 | 1/2 - 1 1/8 | 1/4        | — | 1     | — | 2.20           |
| 32        | TB32L100    | 3.820          | 4 <sup>1</sup> / <sub>16</sub>  | KF-1 | 1610 | 1/2 - 1 1/8 | 1/4        | — | 1     | — | 2.70           |
| 40        | TB40L100    | 4.775          | 5 <sup>1</sup> / <sub>64</sub>  | KF-1 | 2012 | 1/2 - 2     | 1/16       | — | 1 1/4 | — | 3.60           |
| 48        | TB48L100    | 5.730          | 6 <sup>1</sup> / <sub>64</sub>  | KF-1 | 2012 | 1/2 - 2     | 1/16       | — | 1 1/4 | — | 5.10           |
| 60        | TB60L100    | 7.162          | —                               | C-2  | 2012 | 1/2 - 2     | —          | — | 1 1/4 | — | 6.00           |

Dimensions in inches. Weight in pounds  
Pulley O.D. = P.D. - .03"

Type DF

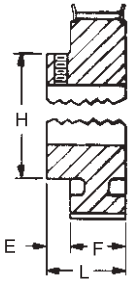

Type D

Type EF

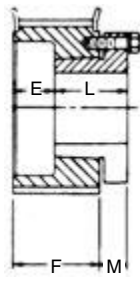

Type E

Type GF

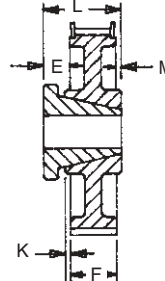

Type G

Type HF

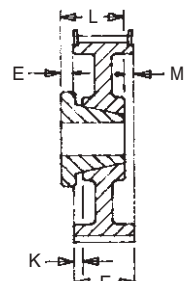

Type H

### H — 1/2" Pitch

H100 For Belts 3/4" and 1" Wide (1/2" Pitch)

Minimum Plain Bore

F = 1 5/16

| No. Teeth | Part Number | Pitch Diameter | Max FL. O.D.                    | Type | Bore |         | Dimensions                     |       |                                 | Wt. |
|-----------|-------------|----------------|---------------------------------|------|------|---------|--------------------------------|-------|---------------------------------|-----|
|           |             |                |                                 |      | Stk. | Max.    | E                              | H     | L                               |     |
| 14        | 14H100      | 2.228          | 2 <sup>31</sup> / <sub>64</sub> | DF-1 | 5/8  | 1       | 3/8                            | 1 1/2 | 1 <sup>15</sup> / <sub>16</sub> | 1.4 |
| 16        | 16H100      | 2.546          | 2 <sup>51</sup> / <sub>64</sub> | DF-1 | 5/8  | 1 1/4   | 1 <sup>1</sup> / <sub>16</sub> | 2     | 2                               | 2.0 |
| 18        | 18H100      | 2.865          | 3 <sup>1</sup> / <sub>64</sub>  | DF-1 | 5/8  | 1 1/2   | 1 <sup>1</sup> / <sub>16</sub> | 2 1/4 | 2                               | 2.8 |
| 20        | 20H100      | 3.183          | 3 <sup>11</sup> / <sub>64</sub> | DF-1 | 5/8  | 1 5/8   | 7/8                            | 2 1/2 | 2 <sup>3</sup> / <sub>16</sub>  | 3.4 |
| 21        | 21H100      | 3.342          | 3 <sup>31</sup> / <sub>64</sub> | DF-1 | 3/4  | 1 11/16 | 1                              | 2 5/8 | 2 1/4                           | 3.8 |
| 22        | 22H100      | 3.501          | 3 <sup>3</sup> / <sub>4</sub>   | DF-1 | 3/4  | 1 7/8   | 1                              | 2 7/8 | 2 <sup>5</sup> / <sub>16</sub>  | 4.3 |
| 24        | 24H100      | 3.820          | 4 <sup>1</sup> / <sub>64</sub>  | DF-1 | 3/4  | 2 1/8   | 1                              | 3 1/8 | 2 <sup>7</sup> / <sub>16</sub>  | 5.3 |
| 26        | 26H100      | 4.138          | 4 <sup>25</sup> / <sub>64</sub> | DF-1 | 3/4  | 2 1/2   | 1-1/8                          | 3 1/2 | 2 <sup>7</sup> / <sub>16</sub>  | 6.7 |
| 28        | 28H100      | 4.456          | 4 <sup>45</sup> / <sub>64</sub> | DF-1 | 3/4  | 2 5/8   | 1-1/8                          | 3 5/8 | 2 <sup>7</sup> / <sub>16</sub>  | 8.0 |

Dimensions in inches. Weight in pounds  
Pulley O.D. = P.D. - .054"

### H — 1/2" Pitch

H100 For Belts 3/4" and 1" Wide (1/2" Pitch)

QD Type

F = 1 5/16

| No. Teeth | Part Number | Pitch Diameter | Max FL. O.D.                    | Type  | Bush | Bore Range    | Dimensions |       |      |         |      | Wt. Less Bush. |
|-----------|-------------|----------------|---------------------------------|-------|------|---------------|------------|-------|------|---------|------|----------------|
|           |             |                |                                 |       |      |               | E          | H     | K    | L       | M    |                |
| 14        | 14H100JA    | 2.228          | 2 <sup>31</sup> / <sub>64</sub> | EF-1* | JA   | 1/2 - 1 1/4   | 3/4        | —     | —    | 1 1/16  | 1/2  | 1.0            |
| 16        | 16H100JA    | 2.546          | 2 <sup>51</sup> / <sub>64</sub> | EF-1* | JA   | 1/2 - 1 1/4   | 3/4        | —     | —    | 1 1/16  | 1/2  | 1.5            |
| 18        | 18H100SH    | 2.865          | 3 <sup>1</sup> / <sub>64</sub>  | EF-1* | SH   | 1/2 - 1 11/16 | 9/16       | —     | —    | 1 5/16  | 9/16 | 1.2            |
| 20        | 20H100SH    | 3.183          | 3 <sup>11</sup> / <sub>64</sub> | EF-1* | SH   | 1/2 - 1 11/16 | 9/16       | —     | —    | 1 9/16  | 9/16 | 1.2            |
| 22        | 22H100SDS   | 3.501          | 3 <sup>3</sup> / <sub>4</sub>   | EF-1* | SDS  | 1/2 - 2       | 9/16       | —     | —    | 1 9/16  | 9/16 | 1.4            |
| 24        | 24H100SDS   | 3.820          | 4 <sup>1</sup> / <sub>64</sub>  | EF-1* | SDS  | 1/2 - 2       | 9/16       | —     | —    | 1 3/8   | 3/8  | 1.7            |
| 26        | 26H100SDS   | 4.138          | 4 <sup>25</sup> / <sub>64</sub> | HF-1  | SDS  | 1/2 - 2       | 1/16       | —     | 9/16 | 1 3/8   | —    | 2.0            |
| 28        | 28H100SDS   | 4.456          | 4 <sup>45</sup> / <sub>64</sub> | HF-1  | SDS  | 1/2 - 2       | 1/16       | —     | 9/16 | 1 3/8   | —    | 2.6            |
| 30        | 30H100SD    | 4.775          | 5 <sup>1</sup> / <sub>64</sub>  | GF-1  | SD   | 1/2 - 2       | 5/8        | —     | —    | 1 13/16 | —    | 3.0            |
| 32        | 32H100SK    | 5.093          | 5 <sup>31</sup> / <sub>64</sub> | GF-1  | SK   | 1/2 - 2 5/8   | 1 1/16     | —     | —    | 1 15/16 | —    | 4.9            |
| 36        | 36H100SK    | 5.730          | 5 <sup>51</sup> / <sub>64</sub> | GF-1  | SK   | 1/2 - 2 5/8   | 1 1/16     | —     | —    | 1 15/16 | —    | 5.6            |
| 40        | 40H100SK    | 6.366          | 6 <sup>31</sup> / <sub>64</sub> | GF-1  | SK   | 1/2 - 2 5/8   | 1 1/16     | —     | —    | 1 15/16 | —    | 8.2            |
| 44        | 44H100SK    | 7.003          | 7 <sup>1</sup> / <sub>4</sub>   | GF-1  | SK   | 1/2 - 2 5/8   | 1 1/16     | —     | —    | 1 15/16 | —    | 10.0           |
| 48        | 48H100SK    | 7.639          | 8 <sup>1</sup> / <sub>64</sub>  | GF-2  | SK   | 1/2 - 2 5/8   | 1 1/16     | —     | —    | 1 15/16 | —    | 12.5           |
| 60        | 60H100SF    | 9.549          | —                               | H-2   | SF   | 1/2 - 2 15/16 | 1 1/16     | —     | —    | 2 1/16  | —    | 10.9           |
| 72        | 72H100SF    | 11.459         | —                               | H-3   | SF   | 1/2 - 2 15/16 | 1 1/16     | —     | —    | 2 1/16  | —    | 14.0           |
| 84        | 84H100SF    | 13.369         | —                               | H-3   | SF   | 1/2 - 2 15/16 | 1 1/16     | 5 1/8 | —    | 2 1/16  | —    | 20.0           |
| 96        | 96H100SF    | 15.279         | —                               | H-3   | SF   | 1/2 - 2 15/16 | 1 1/16     | 5 1/8 | —    | 2 1/16  | —    | 27.0           |
| 120       | 120H100SF   | 19.099         | —                               | H-3   | SF   | 1/2 - 2 15/16 | 1 1/16     | 5 1/8 | —    | 2 1/16  | —    | 38.0           |

Dimensions in inches. Weight in pounds  
Pulley O.D. = P.D. - .054"  
\*Reverse mount only

# H 1/2" Pitch

## Stock Timing Pulleys

Type CF

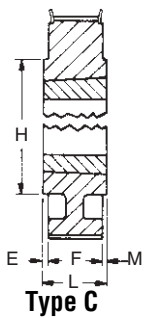

Type DF

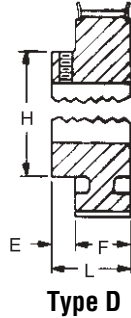

Type EF

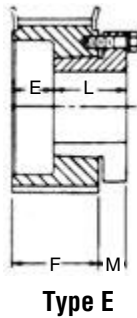

Type GF

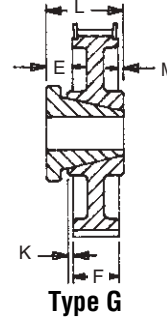

Type HF

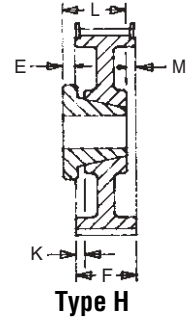

Dash 1 = Solid Style    Dash 2 = Web Style    Dash 3 = Arm/Spoke Style

"F" in description indicates flanged.

### H — 1/2" Pitch

H100 For Belts 3/4" and 1" Wide (1/2" Pitch)

Taper Bushed Type

F = 1 5/16

| No. Teeth | Part Number | Pitch Diameter | Max FL. O.D.       | Type | Bush | Bore Range  | Dimensions        |                   |       |                   | Wt. Less Bush. |
|-----------|-------------|----------------|--------------------|------|------|-------------|-------------------|-------------------|-------|-------------------|----------------|
|           |             |                |                    |      |      |             | E                 | H                 | L     | M                 |                |
| 14        | TB14H100    | 2.228          | 2 <sup>31/64</sup> | KF-1 | 1008 | 1/2 - 1     | 7/16              | —                 | 7/8   | —                 | 0.80           |
| 16        | TB16H100    | 2.546          | 2 <sup>51/64</sup> | KF-1 | 1008 | 1/2 - 1     | 7/16              | —                 | 7/8   | —                 | 1.30           |
| 18        | TB18H100    | 2.865          | 3 <sup>1/64</sup>  | KF-1 | 1210 | 1/2 - 1 1/4 | 5/16              | —                 | 1     | —                 | 1.20           |
| 20        | TB20H100    | 3.183          | 3 <sup>7/16</sup>  | KF-1 | 1210 | 1/2 - 1 1/4 | 5/16              | —                 | 1     | —                 | 1.70           |
| 22        | TB22H100    | 3.501          | 3 <sup>3/4</sup>   | KF-1 | 1610 | 1/2 - 1 5/8 | 5/16              | —                 | 1     | —                 | 1.80           |
| 24        | TB24H100    | 3.820          | 4 <sup>1/64</sup>  | KF-1 | 1610 | 1/2 - 1 5/8 | 5/16              | —                 | 1     | —                 | 2.30           |
| 26        | TB26H100    | 4.138          | 4 <sup>29/64</sup> | KF-1 | 2012 | 1/2 - 2     | 1/16              | —                 | 1 1/4 | —                 | 2.60           |
| 28        | TB28H100    | 4.456          | 4 <sup>45/64</sup> | KF-1 | 2012 | 1/2 - 2     | 1/16              | —                 | 1 1/4 | —                 | 2.80           |
| 30        | TB30H100    | 4.775          | 5 <sup>1/64</sup>  | KF-1 | 2012 | 1/2 - 2     | 1/16              | —                 | 1 1/4 | —                 | 4.20           |
| 32        | TB32H100    | 5.093          | 5 <sup>21/64</sup> | CF-1 | 2517 | 1/2 - 2 1/2 | 7/16              | 4 <sup>7/16</sup> | 1 3/4 | —                 | 4.30           |
| 40        | TB40H100    | 6.366          | 6 <sup>37/64</sup> | CF-1 | 2517 | 1/2 - 2 1/2 | 7/16              | 4 <sup>7/16</sup> | 1 3/4 | —                 | 7.80           |
| 48        | TB48H100    | 7.639          | 8 <sup>1/64</sup>  | CF-1 | 2517 | 1/2 - 2 1/2 | 7/16              | 4 <sup>7/16</sup> | 1 3/4 | —                 | 12.10          |
| 60        | TB60H100    | 9.549          | —                  | C-2  | 3020 | 7/8 - 3     | 1 <sup>1/32</sup> | 6 <sup>1/4</sup>  | 2     | 1 <sup>1/32</sup> | 10.30          |

Dimensions in inches. Weight in pounds  
Pulley O.D. = P.D. - .054"

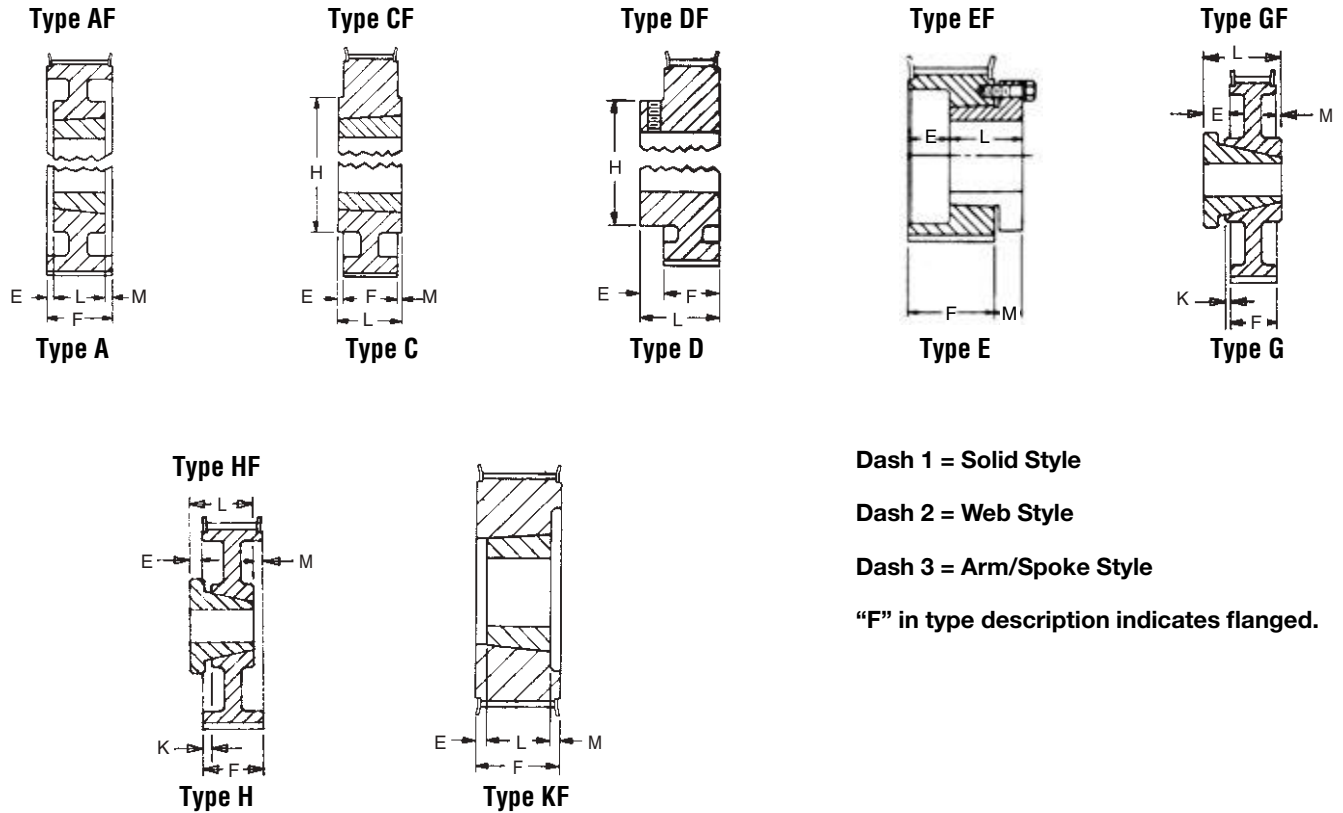

### H — 1/2" Pitch

H150 For Belts 1 1/2" Wide (1/2" Pitch)

Minimum Plain Bore

F = 1 13/16

| No. Teeth | Part Number | Pitch Diameter | Max FL O.D.                     | Type | Bore |         | Dimensions |       |                                 | Wt. |
|-----------|-------------|----------------|---------------------------------|------|------|---------|------------|-------|---------------------------------|-----|
|           |             |                |                                 |      | Stk. | Max.    | E          | H     | L                               |     |
| 14        | 14H150      | 2.228          | 2 <sup>31</sup> / <sub>64</sub> | DF-1 | 3/4  | 1       | 3/8        | 1 1/2 | 2 <sup>7</sup> / <sub>16</sub>  | 1.8 |
| 16        | 16H150      | 2.546          | 2 <sup>51</sup> / <sub>64</sub> | DF-1 | 3/4  | 1 1/4   | 3/4        | 2     | 2 <sup>3</sup> / <sub>16</sub>  | 2.5 |
| 18        | 18H150      | 2.865          | 3 <sup>7</sup> / <sub>64</sub>  | DF-1 | 3/4  | 1 1/2   | 3/4        | 2 1/4 | 2 <sup>7</sup> / <sub>16</sub>  | 3.3 |
| 19        | 19H150      | 3.024          | 3 1/4                           | DF-1 | 3/4  | 1 9/16  | 7/8        | 2 1/4 | 2 <sup>5</sup> / <sub>8</sub>   | 3.9 |
| 20        | 20H150      | 3.183          | 3 <sup>7</sup> / <sub>16</sub>  | DF-1 | 3/4  | 1 5/8   | 7/8        | 2 1/2 | 2 <sup>1</sup> / <sub>16</sub>  | 4.3 |
| 21        | 21H150      | 3.342          | 3 <sup>9</sup> / <sub>16</sub>  | DF-1 | 3/4  | 1 11/16 | 15/16      | 2 1/2 | 2 <sup>3</sup> / <sub>4</sub>   | 5.3 |
| 22        | 22H150      | 3.501          | 3 3/4                           | DF-1 | 3/4  | 1 7/8   | 1          | 2 5/8 | 2 <sup>13</sup> / <sub>16</sub> | 5.4 |
| 24        | 24H150      | 3.820          | 4 <sup>1</sup> / <sub>16</sub>  | DF-1 | 3/4  | 2 1/8   | 1          | 3 1/8 | 2 <sup>13</sup> / <sub>16</sub> | 6.5 |
| 26        | 26H150      | 4.138          | 4 <sup>25</sup> / <sub>32</sub> | DF-1 | 3/4  | 2 1/2   | 1          | 3 1/2 | 2 <sup>13</sup> / <sub>16</sub> | 8.4 |

Dimensions in inches. Weight in pounds  
Pulley O.D. = P.D. - .054"

# H 1/2" Pitch

## Stock Timing Pulleys

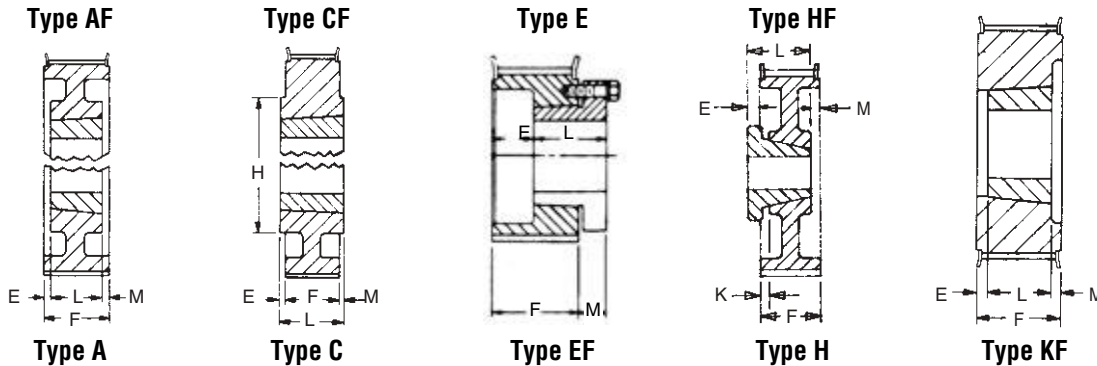

Dash 1 = Solid Style    Dash 2 = Web Style    Dash 3 = Arm/Spoke Style

"F" in type description indicates flanged.

### H — 1/2" Pitch

H150 For Belts 1 1/2" Wide (1/2" Pitch)

QD Type

F = 1 13/16

| No. Teeth | Part Number | Pitch Diameter | Max FL O.D.                     | Type  | Bush. | Bore Range     | Dimensions |      |         |      | Wt. Less Bush. |
|-----------|-------------|----------------|---------------------------------|-------|-------|----------------|------------|------|---------|------|----------------|
|           |             |                |                                 |       |       |                | E          | K    | L       | M    |                |
| 14        | 14H150JA    | 2.228          | 2 <sup>31</sup> / <sub>64</sub> | EF-1* | JA    | 1/2 - 1 1/4    | 1 1/4      | —    | 1 1/16  | 1/2  | 1.5            |
| 16        | 16H150JA    | 2.546          | 2 <sup>51</sup> / <sub>64</sub> | EF-1* | JA    | 1/2 - 1 1/4    | 1 1/4      | —    | 1 1/16  | 1/2  | 2.0            |
| 18        | 18H150SH    | 2.865          | 3 <sup>7</sup> / <sub>64</sub>  | EF-1* | SH    | 1/2 - 1 1 1/16 | 1          | —    | 1 5/16  | 9/16 | 1.3            |
| 20        | 20H150SH    | 3.183          | 3 <sup>7</sup> / <sub>16</sub>  | EF-1* | SH    | 1/2 - 1 1 1/16 | 1          | —    | 1 5/16  | 9/16 | 1.8            |
| 22        | 22H150SD    | 3.501          | 3 3/4                           | EF-1* | SD    | 1/2 - 2        | 9/16       | —    | 1 13/16 | 5/8  | 2.0            |
| 24        | 24H150SD    | 3.820          | 4 1/16                          | EF-1* | SD    | 1/2 - 2        | 9/16       | —    | 1 13/16 | 5/8  | 2.6            |
| 26        | 26H150SD    | 4.138          | 4 <sup>29</sup> / <sub>64</sub> | HF-1  | SD    | 1/2 - 2        | 1/16       | 9/16 | 1 13/16 | 1/16 | 3.0            |
| 28        | 28H150SD    | 4.456          | 4 <sup>45</sup> / <sub>64</sub> | HF-1  | SD    | 1/2 - 2        | 1/16       | 9/16 | 1 13/16 | 1/16 | 4.0            |
| 30        | 30H150SD    | 4.775          | 5 <sup>7</sup> / <sub>64</sub>  | HF-1  | SD    | 1/2 - 2        | 1/16       | 9/16 | 1 13/16 | 1/16 | 4.9            |
| 32        | 32H150SK    | 5.093          | 5 <sup>21</sup> / <sub>64</sub> | HF-1  | SK    | 1/2 - 2 3/8    | 1/8        | 9/16 | 1 15/16 | 0    | 5.8            |
| 36        | 36H150SK    | 5.730          | 5 <sup>57</sup> / <sub>64</sub> | HF-1  | SK    | 1/2 - 2 3/8    | 1/8        | 9/16 | 1 15/16 | 0    | 7.0            |
| 40        | 40H150SK    | 6.366          | 6 <sup>37</sup> / <sub>64</sub> | HF-1  | SK    | 1/2 - 2 3/8    | 1/8        | 9/16 | 1 15/16 | 0    | 9.2            |
| 44        | 44H150SK    | 7.003          | 7 1/4                           | HF-1  | SK    | 1/2 - 2 3/8    | 1/8        | 9/16 | 1 15/16 | 0    | 11.0           |
| 48        | 48H150SK    | 7.639          | 8 <sup>7</sup> / <sub>64</sub>  | HF-2  | SK    | 1/2 - 2 3/8    | 1/8        | 9/16 | 1 15/16 | 0    | 13.7           |
| 60        | 60H150SF    | 9.549          | —                               | H-2   | SF    | 1/2 - 2 15/16  | 13/32      | 9/32 | 2 1/16  | 9/32 | 12.5           |
| 72        | 72H150SF    | 11.459         | —                               | H-3   | SF    | 1/2 - 2 15/16  | 13/32      | 9/32 | 2 1/16  | 9/32 | 17.0           |
| 84        | 84H150SF    | 13.369         | —                               | H-3   | SF    | 1/2 - 2 15/16  | 13/32      | 9/32 | 2 1/16  | 9/32 | 21.5           |
| 96        | 96H150SF    | 15.279         | —                               | H-3   | SF    | 1/2 - 2 15/16  | 13/32      | 9/32 | 2 1/16  | 9/32 | 31.0           |
| 120       | 120H150SF   | 19.099         | —                               | H-3   | SF    | 1/2 - 2 15/16  | 13/32      | 9/32 | 2 1/16  | 9/32 | 40.0           |

Dimensions in inches. Weight in pounds

Pulley O.D. = P.D. - .054"

\*Reverse mount only

### H — 1/2" Pitch

H150 For Belts 1 1/2" Wide (1/2" Pitch)

Taper Bushed Type

F = 1 13/16

| No. Teeth | Part Number | Pitch Diameter | Max FL O.D.                     | Type | Bush | Bore Range  | Dimensions |       |      |       |       | Wt. Less Bush. |
|-----------|-------------|----------------|---------------------------------|------|------|-------------|------------|-------|------|-------|-------|----------------|
|           |             |                |                                 |      |      |             | E          | H     | K    | L     | M     |                |
| 14        | TB14H150    | 2.228          | 2 <sup>31</sup> / <sub>64</sub> | KF-1 | 1008 | 1/2 - 1     | 15/32      | —     | —    | 7/8   | 15/32 | 1.0            |
| 16        | TB16H150    | 2.546          | 2 <sup>51</sup> / <sub>64</sub> | KF-1 | 1008 | 1/2 - 1     | 15/32      | —     | —    | 7/8   | 15/32 | 1.5            |
| 18        | TB18H150    | 2.865          | 3 <sup>7</sup> / <sub>64</sub>  | KF-1 | 1215 | 1/2 - 1 1/4 | 5/16       | —     | —    | 1 1/2 | —     | 1.6            |
| 20        | TB20H150    | 3.183          | 3 <sup>7</sup> / <sub>16</sub>  | KF-1 | 1215 | 1/2 - 1 1/4 | 5/16       | —     | —    | 1 1/2 | —     | 2.2            |
| 22        | TB22H150    | 3.501          | 3 3/4                           | KF-1 | 1615 | 1/2 - 1 5/8 | 5/16       | —     | —    | 1 1/2 | —     | 2.5            |
| 24        | TB24H150    | 3.820          | 4 1/16                          | KF-1 | 2012 | 1/2 - 2     | 9/16       | —     | —    | 1 1/4 | —     | 2.7            |
| 26        | TB26H150    | 4.138          | 4 <sup>29</sup> / <sub>64</sub> | KF-1 | 2012 | 1/2 - 2     | 9/16       | —     | —    | 1 1/4 | —     | 3.2            |
| 28        | TB28H150    | 4.456          | 4 <sup>45</sup> / <sub>64</sub> | KF-1 | 2012 | 1/2 - 2     | 9/16       | —     | —    | 1 1/4 | —     | 4.1            |
| 30        | TB30H150    | 4.775          | 5 <sup>7</sup> / <sub>64</sub>  | KF-1 | 2012 | 1/2 - 2     | 9/16       | —     | —    | 1 1/4 | —     | 5.1            |
| 32        | TB32H150    | 5.093          | 5 <sup>21</sup> / <sub>64</sub> | KF-1 | 2517 | 1/2 - 2 1/2 | 1/16       | —     | —    | 1 3/4 | —     | 5.6            |
| 40        | TB40H150    | 6.366          | 6 <sup>37</sup> / <sub>64</sub> | KF-1 | 2517 | 1/2 - 2 1/2 | 1/16       | —     | —    | 1 3/4 | —     | 8.6            |
| 48        | TB48H150    | 7.639          | 8 <sup>7</sup> / <sub>64</sub>  | AF-1 | 2517 | 1/2 - 2 1/2 | —          | —     | 1/16 | 1 3/4 | 1/16  | 13.6           |
| 60        | TB60H150    | 9.549          | —                               | C-2  | 3020 | 7/8 - 3     | 3/32       | 6-1/4 | —    | 2     | 3/32  | 12.3           |

Dimensions in inches. Weight in pounds

Pulley O.D. = P.D. - .054"

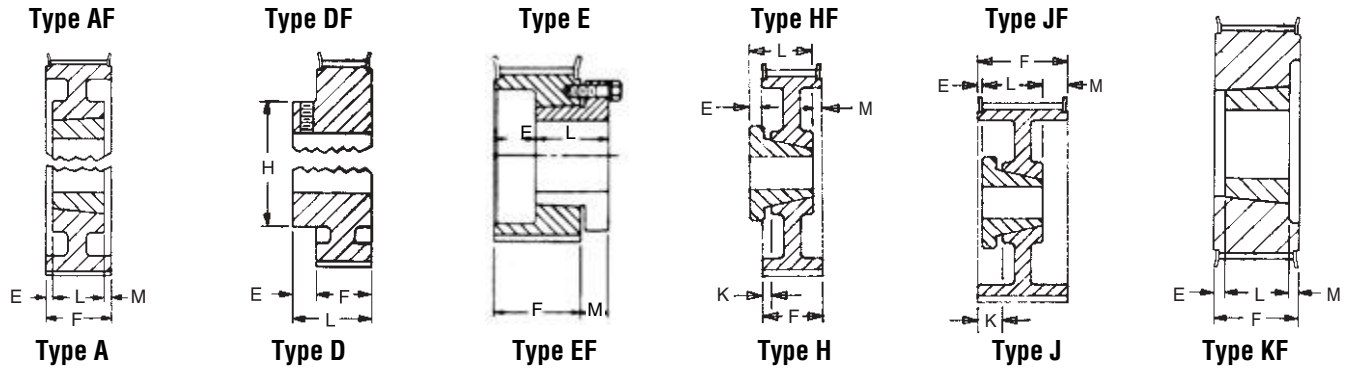

Dash 1 = Solid Style    Dash 2 = Web Style    Dash 3 = Arm/Spoke Style

"F" in type description indicates flanged.

### H — 1/2" Pitch

H200 For Belts 2" Wide (1/2" Pitch)

Minimum Plain Bore

F = 2-11/32

| No. Teeth | Part Number | Pitch Diameter | Max FL O.D. | Type | Bore |       | Dimensions |       |         | Wt. |
|-----------|-------------|----------------|-------------|------|------|-------|------------|-------|---------|-----|
|           |             |                |             |      | Stk. | Max.  | E          | H     | L       |     |
| 14        | 14H200      | 2.228          | 2 3/8       | DF-1 | 3/4  | 1     | 5/8        | 1 1/2 | 2 31/32 | 2.2 |
| 16        | 16H200      | 2.546          | 2 5/16      | DF-1 | 3/4  | 1 1/4 | 3/4        | 2     | 3 3/32  | 3.1 |
| 18        | 18H200      | 2.865          | 3 3/16      | DF-1 | 3/4  | 1 1/2 | 3/4        | 2     | 3 3/32  | 3.7 |
| 19        | 19H200      | 3.024          | 3 1/4       | DF-1 | 3/4  | 1 5/8 | 7/8        | 2 1/4 | 3 3/32  | 3.9 |
| 20        | 20H200      | 3.183          | 3 7/16      | DF-1 | 3/4  | 1 3/4 | 7/8        | 2 1/2 | 3 3/32  | 4.9 |
| 22        | 22H200      | 3.501          | 3 3/4       | DF-1 | 1    | 1 3/4 | 1          | 2 3/8 | 3 11/32 | 6.3 |
| 24        | 24H200      | 3.820          | 4 1/16      | DF-1 | 1    | 2 1/8 | 1          | 3 1/8 | 3 11/32 | 7.5 |
| 26        | 26H200      | 4.138          | 4 25/32     | DF-1 | 1    | 2 1/2 | 1-1/8      | 3 1/2 | 3 15/32 | 9.5 |

Dimensions in inches. Weight in pounds  
Pulley O.D. = P.D. - .054"

# H 1/2" Pitch

## Stock Timing Pulleys

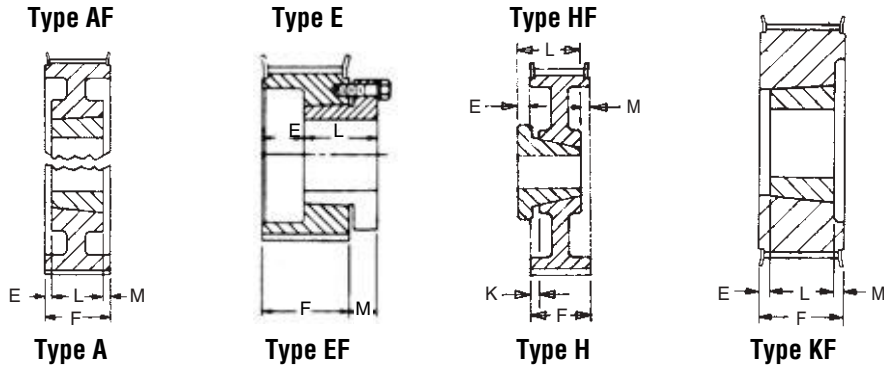

Dash 1 = Solid Style    Dash 2 = Web Style    Dash 3 = Arm/Spoke Style

"F" in type description indicates flanged.

### H — 1/2" Pitch

H200 For Belts 2" Wide (1/2" Pitch)

QD Type

F = 2-11/32

| No. Teeth | Part Number | Pitch Diameter | Max. FL. O.D.                   | Type  | Bush | Bore Range                           | Dimensions                      |                                |                                 |                                | Wt. Less Bush. |
|-----------|-------------|----------------|---------------------------------|-------|------|--------------------------------------|---------------------------------|--------------------------------|---------------------------------|--------------------------------|----------------|
|           |             |                |                                 |       |      |                                      | E                               | K                              | L                               | M                              |                |
| 16        | 16H200JA    | 2.546          | 2 <sup>51</sup> / <sub>64</sub> | EF-1* | JA   | 1/2 - 1/4                            | 1 <sup>25</sup> / <sub>32</sub> | —                              | 1 <sup>1</sup> / <sub>16</sub>  | 1/2                            | 2.6            |
| 18        | 18H200SH    | 2.865          | 3 <sup>7</sup> / <sub>64</sub>  | EF-1* | SH   | 1/2 - 1 <sup>1</sup> / <sub>16</sub> | 1 <sup>17</sup> / <sub>32</sub> | —                              | 1 <sup>3</sup> / <sub>16</sub>  | 9 <sup>1</sup> / <sub>16</sub> | 1.6            |
| 20        | 20H200SH    | 3.183          | 3 <sup>7</sup> / <sub>16</sub>  | EF-1* | SH   | 1/2 - 1 <sup>1</sup> / <sub>16</sub> | 1 <sup>17</sup> / <sub>32</sub> | —                              | 1 <sup>5</sup> / <sub>16</sub>  | 9 <sup>1</sup> / <sub>16</sub> | 2.2            |
| 22        | 22H200SD    | 3.501          | 3 <sup>3</sup> / <sub>4</sub>   | EF-1* | SD   | 1/2 - 2                              | 1 <sup>7</sup> / <sub>32</sub>  | —                              | 1 <sup>13</sup> / <sub>16</sub> | 5 <sup>1</sup> / <sub>8</sub>  | 2.5            |
| 24        | 24H200SD    | 3.820          | 4 <sup>1</sup> / <sub>16</sub>  | EF-1* | SD   | 1/2 - 2                              | 1 <sup>7</sup> / <sub>32</sub>  | —                              | 1 <sup>13</sup> / <sub>16</sub> | 5 <sup>1</sup> / <sub>8</sub>  | 3.0            |
| 26        | 26H200SD    | 4.138          | 4 <sup>25</sup> / <sub>64</sub> | HF-1  | SD   | 1/2 - 2                              | 5 <sup>1</sup> / <sub>64</sub>  | 3 <sup>5</sup> / <sub>64</sub> | 1 <sup>13</sup> / <sub>16</sub> | 3 <sup>5</sup> / <sub>64</sub> | 3.9            |
| 28        | 28H200SD    | 4.456          | 4 <sup>45</sup> / <sub>64</sub> | HF-1  | SD   | 1/2 - 2                              | 5 <sup>1</sup> / <sub>64</sub>  | 3 <sup>5</sup> / <sub>64</sub> | 1 <sup>13</sup> / <sub>16</sub> | 3 <sup>5</sup> / <sub>64</sub> | 4.7            |
| 30        | 30H200SD    | 4.775          | 5 <sup>1</sup> / <sub>64</sub>  | HF-1  | SD   | 1/2 - 2                              | 5 <sup>1</sup> / <sub>64</sub>  | 3 <sup>5</sup> / <sub>64</sub> | 1 <sup>13</sup> / <sub>16</sub> | 3 <sup>5</sup> / <sub>64</sub> | 5.7            |
| 32        | 32H200SK    | 5.093          | 5 <sup>21</sup> / <sub>64</sub> | HF-1  | SK   | 1/2 - 2 <sup>3</sup> / <sub>8</sub>  | 5 <sup>1</sup> / <sub>64</sub>  | 3 <sup>5</sup> / <sub>64</sub> | 1 <sup>15</sup> / <sub>16</sub> | 3 <sup>5</sup> / <sub>64</sub> | 6.7            |
| 36        | 36H200SK    | 5.730          | 5 <sup>51</sup> / <sub>64</sub> | HF-1  | SK   | 1/2 - 2 <sup>3</sup> / <sub>8</sub>  | 5 <sup>1</sup> / <sub>64</sub>  | 3 <sup>5</sup> / <sub>64</sub> | 1 <sup>15</sup> / <sub>16</sub> | 3 <sup>5</sup> / <sub>64</sub> | 8.0            |
| 40        | 40H200SK    | 6.366          | 6 <sup>27</sup> / <sub>64</sub> | HF-1  | SK   | 1/2 - 2 <sup>3</sup> / <sub>8</sub>  | 5 <sup>1</sup> / <sub>64</sub>  | 3 <sup>5</sup> / <sub>64</sub> | 1 <sup>15</sup> / <sub>16</sub> | 3 <sup>5</sup> / <sub>64</sub> | 10.2           |
| 44        | 44H200SK    | 7.003          | 7 <sup>1</sup> / <sub>4</sub>   | HF-1  | SK   | 1/2 - 2 <sup>3</sup> / <sub>8</sub>  | 5 <sup>1</sup> / <sub>64</sub>  | 3 <sup>5</sup> / <sub>64</sub> | 1 <sup>15</sup> / <sub>16</sub> | 3 <sup>5</sup> / <sub>64</sub> | 12.5           |
| 48        | 48H200SF    | 7.639          | 8 <sup>7</sup> / <sub>64</sub>  | HF-2  | SF   | 1/2 - 2 <sup>1</sup> / <sub>16</sub> | 5 <sup>1</sup> / <sub>64</sub>  | 3 <sup>5</sup> / <sub>64</sub> | 2 <sup>1</sup> / <sub>16</sub>  | 3 <sup>5</sup> / <sub>64</sub> | 14.1           |
| 60        | 60H200SF    | 9.549          | —                               | H-2   | SF   | 1/2 - 2 <sup>1</sup> / <sub>16</sub> | 5 <sup>1</sup> / <sub>64</sub>  | 3 <sup>5</sup> / <sub>64</sub> | 2 <sup>1</sup> / <sub>16</sub>  | 3 <sup>5</sup> / <sub>64</sub> | 14.6           |
| 72        | 72H200SF    | 11.459         | —                               | H-3   | SF   | 1/2 - 2 <sup>1</sup> / <sub>16</sub> | 5 <sup>1</sup> / <sub>64</sub>  | 3 <sup>5</sup> / <sub>64</sub> | 2 <sup>1</sup> / <sub>16</sub>  | 3 <sup>5</sup> / <sub>64</sub> | 21.0           |
| 84        | 84H200SF    | 13.369         | —                               | H-3   | SF   | 1/2 - 2 <sup>1</sup> / <sub>16</sub> | 5 <sup>1</sup> / <sub>64</sub>  | 3 <sup>5</sup> / <sub>64</sub> | 2 <sup>3</sup> / <sub>16</sub>  | 3 <sup>5</sup> / <sub>64</sub> | 23.0           |
| 96        | 96H200E     | 15.279         | —                               | H-3   | E    | 7/8 - 3 <sup>1</sup> / <sub>2</sub>  | 3 <sup>3</sup> / <sub>64</sub>  | 2 <sup>3</sup> / <sub>64</sub> | 2 <sup>5</sup> / <sub>8</sub>   | 2 <sup>3</sup> / <sub>64</sub> | 34.0           |
| 120       | 120H200E    | 19.099         | —                               | H-3   | E    | 7/8 - 3 <sup>1</sup> / <sub>2</sub>  | 3 <sup>3</sup> / <sub>64</sub>  | 2 <sup>3</sup> / <sub>64</sub> | 2 <sup>5</sup> / <sub>8</sub>   | 2 <sup>3</sup> / <sub>64</sub> | 42.0           |

Dimensions in inches. Weight in pounds

Pulley O.D. = P.D. - .054"

\*Reverse mount only

### H — 1/2" Pitch

H200 For Belts 2" Wide (1/2" Pitch)

Taper Bushed Type

F = 2-11/32

| No. Teeth | Part Number | Pitch Diameter | Max. FL. O.D.                   | Type | Bush | Bore Range                          | Dimensions                     |                               |                                 | Wt. Less Bush. |
|-----------|-------------|----------------|---------------------------------|------|------|-------------------------------------|--------------------------------|-------------------------------|---------------------------------|----------------|
|           |             |                |                                 |      |      |                                     | E                              | L                             | M                               |                |
| 16        | TB16H200    | 2.546          | 2 <sup>51</sup> / <sub>64</sub> | KF-1 | 1008 | 1/2 - 1                             | 3 <sup>1</sup> / <sub>4</sub>  | 7 <sup>1</sup> / <sub>8</sub> | 2 <sup>3</sup> / <sub>32</sub>  | 1.9            |
| 18        | TB18H200    | 2.865          | 3 <sup>7</sup> / <sub>64</sub>  | KF-1 | 1215 | 1/2 - 1 <sup>1</sup> / <sub>4</sub> | 7 <sup>1</sup> / <sub>16</sub> | 1 <sup>1</sup> / <sub>2</sub> | 1 <sup>19</sup> / <sub>32</sub> | 1.8            |
| 20        | TB20H200    | 3.183          | 3 <sup>3</sup> / <sub>16</sub>  | KF-1 | 1215 | 1/2 - 1 <sup>1</sup> / <sub>4</sub> | 2 <sup>7</sup> / <sub>64</sub> | 1 <sup>1</sup> / <sub>2</sub> | 2 <sup>7</sup> / <sub>64</sub>  | 2.6            |
| 22        | TB22H200    | 3.501          | 3 <sup>3</sup> / <sub>4</sub>   | KF-1 | 1615 | 1/2 - 1 <sup>5</sup> / <sub>8</sub> | 2 <sup>7</sup> / <sub>64</sub> | 1 <sup>1</sup> / <sub>2</sub> | 2 <sup>7</sup> / <sub>64</sub>  | 2.8            |
| 24        | TB24H200    | 3.820          | 4 <sup>1</sup> / <sub>16</sub>  | KF-1 | 2012 | 1/2 - 2                             | 3 <sup>5</sup> / <sub>64</sub> | 1 <sup>1</sup> / <sub>4</sub> | 3 <sup>5</sup> / <sub>64</sub>  | 2.8            |
| 26        | TB26H200    | 4.138          | 4 <sup>25</sup> / <sub>64</sub> | KF-1 | 2012 | 1/2 - 2                             | 3 <sup>5</sup> / <sub>64</sub> | 1 <sup>1</sup> / <sub>4</sub> | 3 <sup>5</sup> / <sub>64</sub>  | 3.6            |
| 28        | TB28H200    | 4.456          | 4 <sup>45</sup> / <sub>64</sub> | KF-1 | 2012 | 1/2 - 2                             | 3 <sup>5</sup> / <sub>64</sub> | 1 <sup>1</sup> / <sub>4</sub> | 3 <sup>5</sup> / <sub>64</sub>  | 5.1            |
| 30        | TB30H200    | 4.775          | 5 <sup>1</sup> / <sub>64</sub>  | KF-1 | 2012 | 1/2 - 2                             | 1 <sup>1</sup> / <sub>32</sub> | 1 <sup>1</sup> / <sub>4</sub> | —                               | 7.0            |
| 32        | TB32H200    | 5.093          | 5 <sup>21</sup> / <sub>64</sub> | KF-1 | 2517 | 1/2 - 2 <sup>1</sup> / <sub>2</sub> | 1 <sup>9</sup> / <sub>32</sub> | 1 <sup>1</sup> / <sub>4</sub> | —                               | 8.5            |
| 40        | TB40H200    | 6.366          | 6 <sup>37</sup> / <sub>64</sub> | KF-1 | 2517 | 1/2 - 2 <sup>1</sup> / <sub>2</sub> | 1 <sup>9</sup> / <sub>32</sub> | 1 <sup>3</sup> / <sub>4</sub> | —                               | 9.9            |
| 48        | TB48H200    | 7.639          | 8 <sup>7</sup> / <sub>64</sub>  | KF-1 | 3020 | 7/8 - 3                             | 1 <sup>1</sup> / <sub>32</sub> | 2                             | —                               | 14.3           |
| 60        | TB60H200    | 9.549          | —                               | A-2  | 3020 | 7/8 - 3                             | 1 <sup>1</sup> / <sub>64</sub> | 2                             | 1 <sup>1</sup> / <sub>64</sub>  | 15.3           |

Dimensions in inches. Weight in pounds

Pulley O.D. = P.D. - .054"





# Stock Timing Pulleys

# H 1/2" Pitch

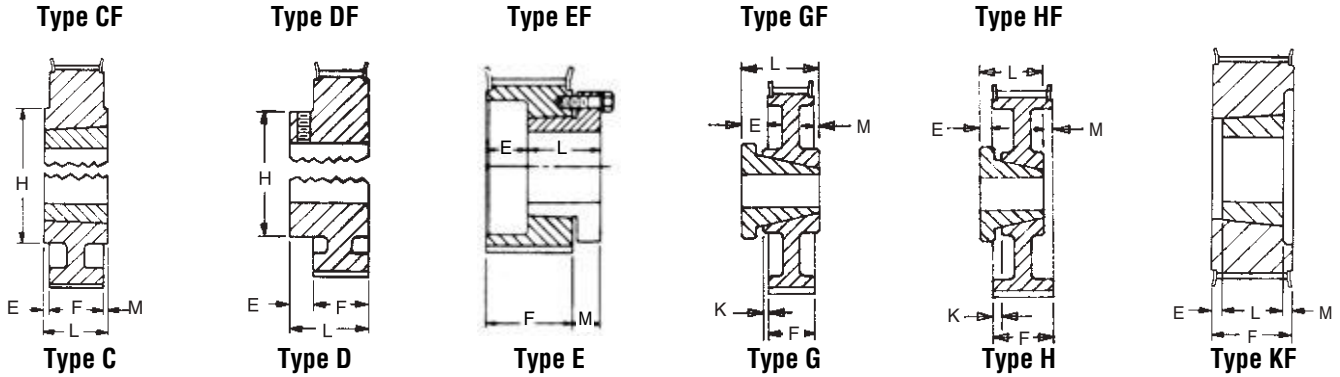

Dash 1 = Solid Style

Dash 2 = Web Style

Dash 3 = Arm/Spoke Style

## H - 1/2" Pitch

H300 For Belts 3" Wide (1/2" Pitch)

Minimum Plain Bore

F = 3-3/8

| No. Teeth | Part Number | Pitch Diameter | Max. FL. O.D.      | Type | Bore |       | Dimensions |   |       | Wt. |
|-----------|-------------|----------------|--------------------|------|------|-------|------------|---|-------|-----|
|           |             |                |                    |      | Stk. | Max.  | E          | H | L     |     |
| 16        | 16H300      | 2.546          | 2 <sup>51/64</sup> | DF-1 | 3/4  | 1 1/4 | 3/4        | 2 | 4 1/2 | 4.2 |

Dimensions in inches. Weight in pounds  
Pulley O.D. = P.D. - .054"

## H - 1/2" Pitch

H300 For Belts 3" Wide (1/2" Pitch)

QD Type

F = 3-3/8

| No. Teeth | Part Number | Pitch Diameter | Max. FL. O.D.      | Type  | Bush | Bore Range    | Dimensions |        |         |        | Wt. Less Bush. |
|-----------|-------------|----------------|--------------------|-------|------|---------------|------------|--------|---------|--------|----------------|
|           |             |                |                    |       |      |               | E          | K      | L       | M      |                |
| 22        | 22H300SD    | 3.501          | 3 3/4              | EF-1* | SD   | 1/2 - 2       | 2 1/8      | —      | 1 13/16 | 5/8    | 4.1            |
| 24        | 24H300SD    | 3.820          | 4 1/16             | EF-1* | SD   | 1/2 - 2       | 2 1/8      | —      | 1 13/16 | 5/8    | 4.1            |
| 26        | 26H300SD    | 4.138          | 4 <sup>29/64</sup> | JF-1  | SD   | 1/2 - 2       | 7/16       | 1 1/16 | 1 13/16 | 1 1/16 | 5.0            |
| 28        | 28H300SD    | 4.456          | 4 <sup>45/64</sup> | JF-1  | SD   | 1/2 - 2       | 7/16       | 1 1/16 | 1 13/16 | 1 1/16 | 6.0            |
| 30        | 30H300SD    | 4.775          | 5 1/64             | JF-1  | SD   | 1/2 - 2       | 7/16       | 1 1/16 | 1 13/16 | 1 1/16 | 7.2            |
| 32        | 32H300SK    | 5.093          | 5 <sup>21/64</sup> | JF-1  | SK   | 1/2 - 2 3/8   | 3/8        | 1 1/16 | 1 15/16 | 1 1/16 | 8.4            |
| 36        | 36H300SK    | 5.730          | 5 <sup>61/64</sup> | JF-1  | SK   | 1/2 - 2 3/8   | 3/8        | 1 1/16 | 1 15/16 | 1 1/16 | 10.0           |
| 40        | 40H300SK    | 6.366          | 6 <sup>37/64</sup> | JF-1  | SK   | 1/2 - 2 3/8   | 3/8        | 1 1/16 | 1 15/16 | 1 1/16 | 12.2           |
| 44        | 44H300SK    | 7.003          | 7 1/4              | JF-1  | SK   | 1/2 - 2 3/8   | 3/8        | 1 1/16 | 1 15/16 | 1 1/16 | 15.5           |
| 48        | 48H300SF    | 7.639          | 8 1/64             | JF-2  | SF   | 1/2 - 2 15/16 | 3/8        | 1 1/16 | 2 1/16  | 1 1/16 | 16.6           |
| 60        | 60H300SF    | 9.549          | —                  | J-2   | SF   | 1/2 - 2 15/16 | 3/8        | 1 1/16 | 2 1/16  | 1 1/16 | 17.9           |
| 72        | 72H300SF    | 11.459         | —                  | J-2   | SF   | 1/2 - 2 15/16 | 3/16       | 1 1/16 | 2 1/16  | 1 1/16 | 23.0           |
| 84        | 84H300SF    | 13.369         | —                  | J-2   | SF   | 1/2 - 2 15/16 | 3/16       | 1 1/16 | 2 1/16  | 1 1/16 | 30.0           |
| 96        | 96H300E     | 15.279         | —                  | H-3   | E    | 7/8 - 3 1/2   | 0          | 7/8    | 2 5/8   | 7/8    | 38.0           |
| 120       | 120H300E    | 19.099         | —                  | H-3   | E    | 7/8 - 3 1/2   | 0          | 7/8    | 2 5/8   | 7/8    | 51.0           |

Dimensions in inches. Weight in pounds  
Pulley O.D. = P.D. - .054"

\*Reverse mount only

## H - 1/2" Pitch

H300 For Belts 3" Wide (1/2" Pitch)

Taper Bushed Type

F = 3-3/8

| No. Teeth | Part Number | Pitch Diameter | Max. FL. O.D.      | Type | Bush | Bore Range  | Dimensions |       |        | Wt. Less Bush. |
|-----------|-------------|----------------|--------------------|------|------|-------------|------------|-------|--------|----------------|
|           |             |                |                    |      |      |             | E          | L     | M      |                |
| 18        | TB18H300    | 2.865          | 3 3/64             | KF-1 | 1215 | 1/2 - 1 1/4 | 15/16      | 1 1/2 | 15/16  | 2.6            |
| 20        | TB20H300    | 3.183          | 3 3/16             | KF-1 | 1215 | 1/2 - 1 1/4 | 15/16      | 1 1/2 | 15/16  | 3.9            |
| 22        | TB22H300    | 3.501          | 3 3/4              | KF-1 | 1615 | 1/2 - 1 5/8 | 15/16      | 1 1/2 | 15/16  | 4.0            |
| 24        | TB24H300    | 3.820          | 4 1/16             | KF-1 | 2012 | 1/2 - 2     | 1 1/16     | 1 1/4 | 1 1/16 | 4.3            |
| 26        | TB26H300    | 4.138          | 4 <sup>25/64</sup> | KF-1 | 2012 | 1/2 - 2     | 1 1/16     | 1 1/4 | 1 1/16 | 5.4            |
| 28        | TB28H300    | 4.456          | 4 <sup>45/64</sup> | KF-1 | 2012 | 1/2 - 2     | 1 1/16     | 1 1/4 | 1 1/16 | 6.8            |
| 30        | TB30H300    | 4.775          | 5 1/64             | KF-1 | 2012 | 1/2 - 2     | 1 1/16     | 1 1/4 | 1 1/16 | 7.5            |
| 32        | TB32H300    | 5.093          | 5 <sup>21/64</sup> | KF-1 | 2517 | 1/2 - 2 1/2 | 13/16      | 1 3/4 | 13/16  | 7.4            |
| 40        | TB40H300    | 6.366          | 6 <sup>37/64</sup> | KF-1 | 2517 | 1/2 - 2 1/2 | 13/16      | 1 3/4 | 13/16  | 12.1           |
| 48        | TB48H300    | 7.639          | 8 1/64             | KF-1 | 3020 | 7/8 - 3     | 1 1/16     | 2     | 1 1/16 | 16.3           |
| 60        | TB60H300    | 9.549          | —                  | A-2  | 3020 | 7/8 - 3     | 9/16       | 2     | 9/16   | 17.3           |

Dimensions in inches. Weight in pounds  
Pulley O.D. = P.D. - .054"

# XH

7/8" Pitch

## Stock Timing Pulleys

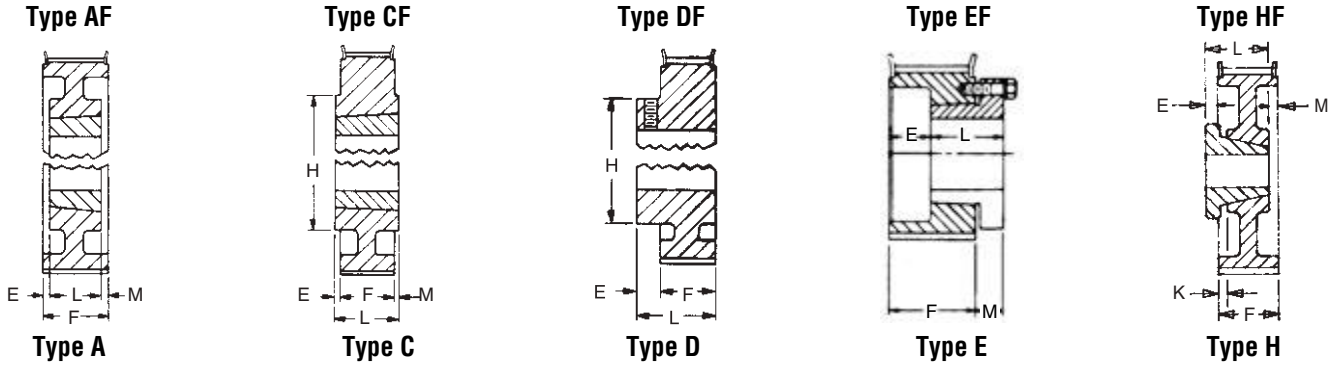

Dash 1 = Solid Style

Dash 2 = Web Style

Dash 3 = Arm/Spoke Style

"F" in type description indicates flanged.

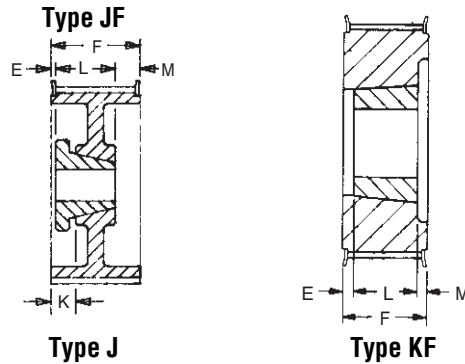

### XH — 7/8" Pitch

XH200 For Belts 2" Wide (7/8" Pitch)

Minimum Plain Bore

F = 2 9/16

| No. Teeth | Part Number | Pitch Diameter | Max. FL O.D. | Type | Bore |       | Dimensions |        |        | Wt.  |
|-----------|-------------|----------------|--------------|------|------|-------|------------|--------|--------|------|
|           |             |                |              |      | Stk. | Max.  | E          | H      | L      |      |
| 18        | 18XH200     | 5.013          | 5 37/64      | DF-1 | 1    | 2 5/8 | 7/8        | 3 1/16 | 3 3/16 | 12.0 |
| 20        | 20XH200     | 5.570          | 6 7/64       | DF-1 | 1    | 3 1/4 | 1          | 4 1/8  | 3 3/16 | 16.0 |

Dimensions in inches. Weight in pounds  
Pulley O.D. = P.D. - .11"

### XH — 7/8" Pitch

XH200 For Belts 2" Wide (7/8" Pitch)

Taper Bushed Type

F = 2 9/16

| No. Teeth | Part Number | Pitch Diameter | Max. FL O.D. | Type | Bush | Bore Range     | Dimensions |       |       |       | Wt. Less Bush. |
|-----------|-------------|----------------|--------------|------|------|----------------|------------|-------|-------|-------|----------------|
|           |             |                |              |      |      |                | E          | H     | L     | M     |                |
| 22        | TB22XH200   | 6.127          | 6 19/32      | KF-1 | 2517 | 1/2 - 2 1/2    | 13/16      | —     | 1 3/4 | —     | 10.6           |
| 24        | TB24XH200   | 6.685          | 7 7/32       | KF-1 | 3020 | 7/8 - 3        | 9/16       | —     | 2     | —     | 11.3           |
| 26        | TB26XH200   | 7.241          | 7 29/32      | KF-1 | 3020 | 7/8 - 3        | 9/16       | —     | 2     | —     | 13.3           |
| 28        | TB28XH200   | 7.799          | 8 17/64      | CF-1 | 3535 | 1 1/16 - 3 1/2 | 15/16      | 6 1/2 | 3 1/2 | —     | 13.5           |
| 30        | TB30XH200   | 8.356          | 9 1/32       | CF-1 | 3535 | 1 1/16 - 3 1/2 | 15/16      | 6 1/2 | 3 1/2 | —     | 18.5           |
| 32        | TB32XH200   | 8.913          | 9 33/64      | CF-1 | 3535 | 1 3/16 - 3 1/2 | 15/16      | 6 1/2 | 3 1/2 | —     | 21.5           |
| 40        | TB40XH200   | 11.141         | 11 57/64     | CF-1 | 4040 | 1 1/16 - 4     | 1 7/16     | 8 1/2 | 4     | —     | 37.5           |
| 48        | TB48XH200   | 13.369         | —            | C-2  | 4040 | 1 1/16 - 4     | 1 3/32     | 8 1/2 | 4     | 23/32 | 44.5           |
| 60        | TB60XH200   | 16.711         | —            | C-3  | 4040 | 1 1/16 - 4     | 23/32      | 8 1/2 | 4     | 23/32 | 47.0           |

Dimensions in inches. Weight in pounds  
Pulley O.D. = P.D. - .11"

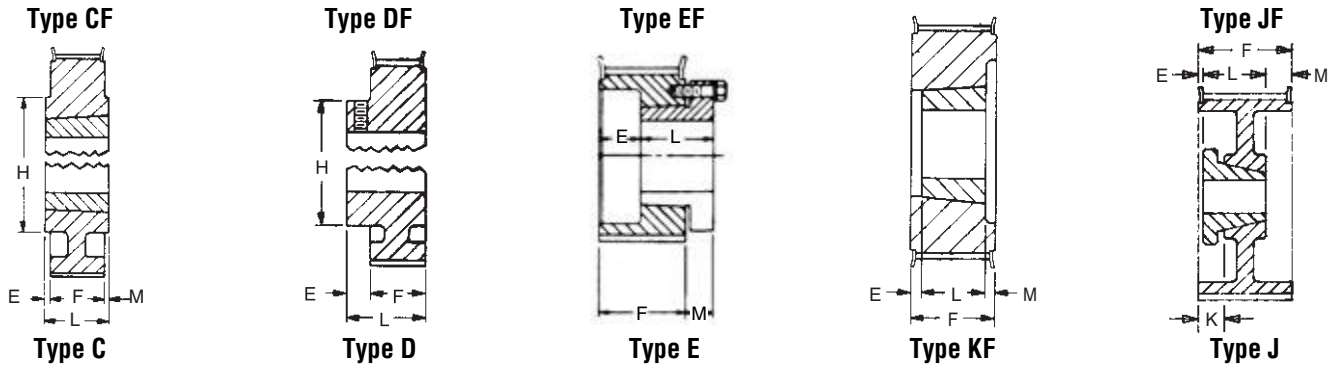

### XH — 7/8" Pitch

XH300 For Belts 3" Wide (7/8" Pitch)

Minimum Plain Bore

F = 3/8"

| No. Teeth | Part Number | Pitch Diameter | Max. FL O.D.                    | Type | Bore |                               | Dimensions |                                |                               |      | Wt.  |
|-----------|-------------|----------------|---------------------------------|------|------|-------------------------------|------------|--------------------------------|-------------------------------|------|------|
|           |             |                |                                 |      | Stk. | Max.                          | E          | H                              | L                             | M    |      |
| 18        | 18XH300     | 5.013          | 5 <sup>37</sup> / <sub>64</sub> | DF-1 | 1    | 2 <sup>5</sup> / <sub>8</sub> | 7/8        | 3 <sup>1</sup> / <sub>16</sub> | 4 <sup>1</sup> / <sub>2</sub> | 1*   | 15.0 |
| 20        | 20XH300     | 5.570          | 6 <sup>7</sup> / <sub>64</sub>  | DF-1 | 1    | 3 <sup>1</sup> / <sub>4</sub> | 1          | 4 <sup>1</sup> / <sub>8</sub>  | 4 <sup>5</sup> / <sub>8</sub> | 3/4* | 19.0 |

\*Counterbore "M" depth on flush side.

### XH — 7/8" Pitch

XH300 For Belts 3" Wide (7/8" Pitch)

Taper Bushed Type

F = 3/8"

| No. Teeth | Part Number | Pitch Diameter | Max. FL O.D.                     | Bore Type | Bush | Bore Range   | Dimensions |                               |                               |       | Wt.  |
|-----------|-------------|----------------|----------------------------------|-----------|------|--|------------|-------------------------------|-------------------------------|-------|------|
|           |             |                |                                  |           |      |  | E          | H                             | L                             | M     |      |
| 22        | TB22XH300   | 6.127          | 6 <sup>21</sup> / <sub>32</sub>  | KF-1      | 2517 | 1/2 - 2 <sup>1</sup> / <sub>2</sub>                            | 15/16      | —                             | 1 <sup>1</sup> / <sub>4</sub> | 15/16 | 13.6 |
| 24        | TB24XH300   | 6.685          | 7 <sup>7</sup> / <sub>32</sub>   | KF-1      | 3020 | 3/8 - 3  | 13/16      | —                             | 2                             | 13/16 | 15.3 |
| 26        | TB26XH300   | 7.241          | 7 <sup>25</sup> / <sub>32</sub>  | KF-1      | 3020 | 3/8 - 3  | 13/16      | —                             | 2                             | 13/16 | 17.3 |
| 28        | TB28XH300   | 7.799          | 8 <sup>17</sup> / <sub>64</sub>  | KF-1      | 3535 | 1 <sup>1</sup> / <sub>16</sub> - 3 <sup>1</sup> / <sub>2</sub> | 1/2        | —                             | 3 <sup>1</sup> / <sub>2</sub> | —     | 17.5 |
| 30        | TB30XH300   | 8.356          | 9 <sup>7</sup> / <sub>32</sub>   | KF-1      | 3535 | 1 <sup>1</sup> / <sub>16</sub> - 3 <sup>1</sup> / <sub>2</sub> | 1/2        | —                             | 3 <sup>1</sup> / <sub>2</sub> | —     | 22.5 |
| 32        | TB32XH300   | 8.913          | 9 <sup>33</sup> / <sub>64</sub>  | KF-1      | 3535 | 1 <sup>1</sup> / <sub>16</sub> - 3 <sup>1</sup> / <sub>2</sub> | 1/2        | —                             | 3 <sup>1</sup> / <sub>2</sub> | —     | 26.5 |
| 40        | TB40XH300   | 11.141         | 11 <sup>57</sup> / <sub>64</sub> | CF-1      | 4040 | 1 <sup>7</sup> / <sub>16</sub> - 4                             | 3/8        | 7 <sup>7</sup> / <sub>8</sub> | 4                             | —     | 43.5 |
| 48        | TB48XH300   | 13.369         | —                                | C-2       | 4040 | 1 <sup>7</sup> / <sub>16</sub> - 4                             | 3/16       | 8 <sup>1</sup> / <sub>2</sub> | 4                             | 3/16  | 51.5 |
| 60        | TB60XH300   | 16.711         | —                                | C-3       | 4040 | 1 <sup>7</sup> / <sub>16</sub> - 4                             | 3/16       | 8 <sup>1</sup> / <sub>2</sub> | 4                             | 3/16  | 55.5 |

### XH — 7/8" Pitch

XH400 For Belts 4" Wide (7/8" Pitch)

QD Type

F = 4<sup>1</sup>/<sub>16</sub>"

| No. Teeth | Part Number | Pitch Diameter | Max. FL O.D.                     | Type | Bush | Bore Range   | Dimensions                     |                                 |                                 |                                 | Wt.   |
|-----------|-------------|----------------|----------------------------------|------|------|--|--------------------------------|---------------------------------|---------------------------------|---------------------------------|-------|
|           |             |                |                                  |      |      |  | E                              | K                               | L                               | M                               |       |
| 20        | 20XH400SK   | 5.570          | 6 <sup>7</sup> / <sub>32</sub>   | JF-1 | SK   | 1/2 - 2 <sup>1</sup> / <sub>2</sub>                            | 1/2                            | 1 <sup>1</sup> / <sub>16</sub>  | 1 <sup>15</sup> / <sub>16</sub> | 2 <sup>1</sup> / <sub>4</sub>   | 12.4  |
| 22        | 22XH400SK   | 6.127          | 6 <sup>21</sup> / <sub>32</sub>  | JF-1 | SK   | 1/2 - 2 <sup>1</sup> / <sub>2</sub>                            | 1/2                            | 1 <sup>1</sup> / <sub>16</sub>  | 1 <sup>15</sup> / <sub>16</sub> | 2 <sup>1</sup> / <sub>4</sub>   | 16.7  |
| 24        | 24XH400SF   | 6.685          | 7 <sup>7</sup> / <sub>32</sub>   | JF-1 | SF   | 1/2 - 2 <sup>1</sup> / <sub>2</sub>                            | 1/2                            | 1 <sup>1</sup> / <sub>16</sub>  | 2 <sup>1</sup> / <sub>16</sub>  | 2 <sup>3</sup> / <sub>16</sub>  | 19.2  |
| 26        | 26XH400SF   | 7.242          | 7 <sup>25</sup> / <sub>32</sub>  | JF-1 | SF   | 1/2 - 2 <sup>1</sup> / <sub>2</sub>                            | 1/2                            | 1 <sup>1</sup> / <sub>16</sub>  | 2 <sup>1</sup> / <sub>16</sub>  | 2 <sup>3</sup> / <sub>16</sub>  | 23.0  |
| 28        | 28XH400E    | 7.799          | 8 <sup>11</sup> / <sub>32</sub>  | JF-1 | E    | 3/8 - 3 <sup>1</sup> / <sub>2</sub>                            | 2 <sup>1</sup> / <sub>32</sub> | 1 <sup>17</sup> / <sub>32</sub> | 2 <sup>5</sup> / <sub>8</sub>   | 1 <sup>13</sup> / <sub>32</sub> | 24.0  |
| 30        | 30XH400E    | 8.356          | 8 <sup>29</sup> / <sub>32</sub>  | JF-1 | E    | 3/8 - 3 <sup>1</sup> / <sub>2</sub>                            | 2 <sup>1</sup> / <sub>32</sub> | 1 <sup>17</sup> / <sub>32</sub> | 2 <sup>5</sup> / <sub>8</sub>   | 1 <sup>13</sup> / <sub>32</sub> | 30.7  |
| 32        | 32XH400E    | 8.913          | 9 <sup>7</sup> / <sub>16</sub>   | JF-1 | E    | 3/8 - 3 <sup>1</sup> / <sub>2</sub>                            | 2 <sup>1</sup> / <sub>32</sub> | 1 <sup>17</sup> / <sub>32</sub> | 2 <sup>5</sup> / <sub>8</sub>   | 1 <sup>13</sup> / <sub>32</sub> | 34.0  |
| 40        | 40XH400F    | 11.141         | 11 <sup>11</sup> / <sub>16</sub> | HF-2 | F    | 1 - 3 <sup>9</sup> / <sub>16</sub>                             | 3/32                           | 1 <sup>13</sup> / <sub>32</sub> | 3 <sup>3</sup> / <sub>8</sub>   | 1 <sup>1</sup> / <sub>32</sub>  | 49.0  |
| 48        | 48XH400J    | 13.369         | —                                | H-3  | J    | 1 <sup>1</sup> / <sub>16</sub> - 4 <sup>1</sup> / <sub>2</sub> | 3/16                           | 1                               | 4 <sup>1</sup> / <sub>2</sub>   | 7/8                             | 67.3  |
| 60        | 60XH400J    | 16.711         | —                                | H-3  | J    | 1 <sup>1</sup> / <sub>16</sub> - 4 <sup>1</sup> / <sub>2</sub> | 7/16                           | 3/4                             | 4 <sup>1</sup> / <sub>2</sub>   | 5/8                             | 85.0  |
| 72        | 72XH400J    | 20.054         | —                                | H-3  | J    | 1 <sup>1</sup> / <sub>16</sub> - 4 <sup>1</sup> / <sub>2</sub> | 7/16                           | 3/4                             | 4 <sup>1</sup> / <sub>2</sub>   | 5/8                             | 108.0 |
| 84        | 84XH400J    | 23.396         | —                                | H-3  | J    | 1 <sup>1</sup> / <sub>16</sub> - 4 <sup>1</sup> / <sub>2</sub> | 7/16                           | 3/4                             | 4 <sup>1</sup> / <sub>2</sub>   | 5/8                             | 119.0 |
| 96        | 96XH400J    | 26.738         | —                                | H-3  | J    | 1 <sup>1</sup> / <sub>16</sub> - 4 <sup>1</sup> / <sub>2</sub> | 7/16                           | 3/4                             | 4 <sup>1</sup> / <sub>2</sub>   | 5/8                             | 187.5 |
| 120       | 120XH400J   | 33.423         | —                                | H-3  | J    | 1 <sup>1</sup> / <sub>16</sub> - 4 <sup>1</sup> / <sub>2</sub> | 7/16                           | 3/4                             | 4 <sup>1</sup> / <sub>2</sub>   | 5/8                             | 187.5 |

Dimensions in inches. Weight in pounds  
Pulley O.D. = P.D. - .11"

# Timing Pulley Diameters

## XL - 1/5" Pitch

| No. Teeth | Diameter |       | No. Teeth | Diameter |       | No. Teeth | Diameter |       | No. Teeth | Diameter |       | No. Teeth | Diameter |       |
|-----------|----------|-------|-----------|----------|-------|-----------|----------|-------|-----------|----------|-------|-----------|----------|-------|
|           | P.D.     | O.D.  |           | P.D.     | O.D.  |           | P.D.     | O.D.  |           | P.D.     | O.D.  |           | P.D.     | O.D.  |
| 10XL      | 0.637    | 0.617 | 33XL      | 2.101    | 2.081 | 55XL      | 3.501    | 3.481 | 77XL      | 4.902    | 4.882 | 99XL      | 6.303    | 6.283 |
| 11XL      | 0.700    | 0.680 | 34XL      | 2.165    | 2.145 | 56XL      | 3.565    | 3.545 | 78XL      | 4.966    | 4.946 | 100XL     | 6.346    | 6.326 |
| 12XL      | 0.764    | 0.744 | 35XL      | 2.228    | 2.208 | 57XL      | 3.629    | 3.609 | 79XL      | 5.029    | 5.009 | 101XL     | 6.430    | 6.410 |
| 13XL      | 0.828    | 0.808 | 36XL      | 2.292    | 2.272 | 58XL      | 3.692    | 3.672 | 80XL      | 5.093    | 5.073 | 102XL     | 6.494    | 6.474 |
| 14XL      | 0.891    | 0.871 | 37XL      | 2.355    | 2.335 | 59XL      | 3.756    | 3.736 | 81XL      | 5.157    | 5.137 | 103XL     | 6.557    | 6.537 |
| 15XL      | 0.955    | 0.935 | 38XL      | 2.419    | 2.399 | 60XL      | 3.820    | 3.800 | 82XL      | 5.220    | 5.200 | 104XL     | 6.621    | 6.601 |
| 16XL      | 1.019    | 0.999 | 39XL      | 2.483    | 2.463 | 61XL      | 3.883    | 3.863 | 83XL      | 5.284    | 5.264 | 105XL     | 6.685    | 6.665 |
| 17XL      | 1.082    | 1.062 | 40XL      | 2.546    | 2.526 | 62XL      | 3.947    | 3.927 | 84XL      | 5.348    | 5.328 | 106XL     | 6.748    | 6.728 |
| 18XL      | 1.146    | 1.126 | 41XL      | 2.610    | 2.590 | 63XL      | 4.011    | 3.991 | 85XL      | 5.411    | 5.391 | 107XL     | 6.812    | 6.792 |
| 19XL      | 1.210    | 1.190 | 42XL      | 2.674    | 2.654 | 64XL      | 4.074    | 4.054 | 86XL      | 5.475    | 5.455 | 108XL     | 6.875    | 6.855 |
| 20XL      | 1.273    | 1.253 | 43XL      | 2.737    | 2.717 | 65XL      | 4.138    | 4.118 | 87XL      | 5.539    | 5.519 | 109XL     | 6.939    | 6.919 |
| 21XL      | 1.337    | 1.317 | 44XL      | 2.801    | 2.781 | 66XL      | 4.202    | 4.182 | 88XL      | 5.602    | 5.582 | 110XL     | 7.003    | 6.983 |
| 22XL      | 1.401    | 1.381 | 45XL      | 2.865    | 2.845 | 67XL      | 4.265    | 4.245 | 89XL      | 5.666    | 5.646 | 111XL     | 7.066    | 7.046 |
| 23XL      | 1.464    | 1.444 | 46XL      | 2.928    | 2.908 | 68XL      | 4.329    | 4.309 | 90XL      | 5.730    | 5.710 | 112XL     | 7.130    | 7.110 |
| 24XL      | 1.528    | 1.508 | 47XL      | 2.992    | 2.972 | 69XL      | 4.393    | 4.373 | 91XL      | 5.793    | 5.773 | 113XL     | 7.194    | 7.174 |
| 25XL      | 1.592    | 1.572 | 48XL      | 3.056    | 3.036 | 70XL      | 4.456    | 4.436 | 92XL      | 5.857    | 5.837 | 114XL     | 7.257    | 7.237 |
| 26XL      | 1.655    | 1.635 | 49XL      | 3.119    | 3.099 | 71XL      | 4.520    | 4.500 | 93XL      | 5.921    | 5.901 | 115XL     | 7.321    | 7.301 |
| 27XL      | 1.719    | 1.699 | 50XL      | 3.183    | 3.163 | 72XL      | 4.584    | 4.564 | 94XL      | 5.984    | 5.964 | 116XL     | 7.385    | 7.365 |
| 28XL      | 1.783    | 1.763 | 51XL      | 3.247    | 3.227 | 73XL      | 4.647    | 4.627 | 95XL      | 6.048    | 6.028 | 117XL     | 7.448    | 7.428 |
| 29XL      | 1.846    | 1.826 | 52XL      | 3.310    | 3.290 | 74XL      | 4.711    | 4.691 | 96XL      | 6.112    | 6.092 | 118XL     | 7.512    | 7.492 |
| 30XL      | 1.910    | 1.890 | 53XL      | 3.374    | 3.354 | 75XL      | 4.775    | 4.755 | 97XL      | 6.175    | 6.155 | 119XL     | 7.576    | 7.556 |
| 31XL      | 1.974    | 1.954 | 54XL      | 3.438    | 3.418 | 76XL      | 4.838    | 4.818 | 98XL      | 6.239    | 6.219 | 120XL     | 7.639    | 7.619 |
| 32XL      | 2.037    | 2.017 |           |          |       |           |          |       |           |          |       |           |          |       |

## L - 3/8" Pitch

| No. Teeth | Diameter |       | No. Teeth | Diameter |       | No. Teeth | Diameter |       | No. Teeth | Diameter |        | No. Teeth | Diameter |        |
|-----------|----------|-------|-----------|----------|-------|-----------|----------|-------|-----------|----------|--------|-----------|----------|--------|
|           | P.D.     | O.D.  |           | P.D.     | O.D.  |           | P.D.     | O.D.  |           | P.D.     | O.D.   |           | P.D.     | O.D.   |
| 10L       | 1.194    | 1.164 | 33L       | 3.939    | 3.909 | 56L       | 6.685    | 6.655 | 79L       | 9.430    | 9.400  | 102L      | 12.175   | 12.145 |
| 11L       | 1.313    | 1.283 | 34L       | 4.058    | 4.028 | 57L       | 6.804    | 6.774 | 80L       | 9.549    | 9.519  | 103L      | 12.295   | 12.265 |
| 12L       | 1.432    | 1.402 | 35L       | 4.178    | 4.148 | 58L       | 6.923    | 6.893 | 81L       | 9.669    | 9.639  | 104L      | 12.414   | 12.384 |
| 13L       | 1.552    | 1.522 | 36L       | 4.297    | 4.267 | 59L       | 7.043    | 7.013 | 82L       | 9.788    | 9.758  | 105L      | 12.533   | 12.503 |
| 14L       | 1.671    | 1.641 | 37L       | 4.417    | 4.387 | 60L       | 7.162    | 7.132 | 83L       | 9.907    | 9.877  | 106L      | 12.653   | 12.623 |
| 15L       | 1.790    | 1.760 | 38L       | 4.536    | 4.506 | 61L       | 7.281    | 7.251 | 84L       | 10.027   | 9.997  | 107L      | 12.772   | 12.742 |
| 16L       | 1.910    | 1.880 | 39L       | 4.655    | 4.625 | 62L       | 7.401    | 7.371 | 85L       | 10.147   | 10.117 | 108L      | 12.892   | 12.862 |
| 17L       | 2.029    | 1.999 | 40L       | 4.775    | 4.745 | 63L       | 7.520    | 7.490 | 86L       | 10.265   | 10.235 | 109L      | 13.011   | 12.981 |
| 18L       | 2.149    | 2.119 | 41L       | 4.894    | 4.864 | 64L       | 7.639    | 7.609 | 87L       | 10.385   | 10.355 | 110L      | 13.130   | 13.100 |
| 19L       | 2.268    | 2.238 | 42L       | 5.013    | 4.983 | 65L       | 7.759    | 7.729 | 88L       | 10.504   | 10.474 | 111L      | 13.250   | 13.220 |
| 20L       | 2.387    | 2.357 | 43L       | 5.133    | 5.103 | 66L       | 7.878    | 7.848 | 89L       | 10.624   | 10.594 | 112L      | 13.369   | 13.339 |
| 21L       | 2.507    | 2.477 | 44L       | 5.252    | 5.222 | 67L       | 7.998    | 7.968 | 90L       | 10.743   | 10.713 | 113L      | 13.488   | 13.458 |
| 22L       | 2.626    | 2.596 | 45L       | 5.371    | 5.341 | 68L       | 8.117    | 8.087 | 91L       | 10.862   | 10.832 | 114L      | 13.608   | 13.578 |
| 23L       | 2.745    | 2.715 | 46L       | 5.491    | 5.461 | 69L       | 8.236    | 8.206 | 92L       | 10.982   | 10.952 | 115L      | 13.727   | 13.697 |
| 24L       | 2.865    | 2.835 | 47L       | 5.610    | 5.580 | 70L       | 8.356    | 8.326 | 93L       | 11.101   | 11.071 | 116L      | 13.846   | 13.816 |
| 25L       | 2.984    | 2.954 | 48L       | 5.730    | 5.700 | 71L       | 8.475    | 8.445 | 94L       | 11.220   | 11.190 | 117L      | 13.966   | 13.936 |
| 26L       | 3.104    | 3.074 | 49L       | 5.849    | 5.819 | 72L       | 8.594    | 8.564 | 95L       | 11.340   | 11.310 | 118L      | 14.085   | 14.055 |
| 27L       | 3.223    | 3.193 | 50L       | 5.968    | 5.938 | 73L       | 8.714    | 8.684 | 96L       | 11.459   | 11.429 | 119L      | 14.205   | 14.175 |
| 28L       | 3.342    | 3.312 | 51L       | 6.088    | 6.058 | 74L       | 8.833    | 8.803 | 97L       | 11.579   | 11.549 | 120L      | 14.324   | 14.294 |
| 29L       | 3.462    | 3.432 | 52L       | 6.207    | 6.177 | 75L       | 8.952    | 8.922 | 98L       | 11.698   | 11.668 | 130L      | 15.518   | 15.488 |
| 30L       | 3.581    | 3.551 | 53L       | 6.326    | 6.296 | 76L       | 9.072    | 9.042 | 99L       | 11.817   | 11.787 | 140L      | 16.711   | 16.681 |
| 31L       | 3.700    | 3.670 | 54L       | 6.446    | 6.416 | 77L       | 9.191    | 9.161 | 100L      | 11.937   | 11.907 | 150L      | 17.905   | 17.875 |
| 32L       | 3.820    | 3.790 | 55L       | 6.565    | 6.535 | 78L       | 9.311    | 9.281 | 101L      | 12.056   | 12.026 |           |          |        |



# Timing Pulley Diameters

## H - 1/2" Pitch

| No. Teeth | Diameter |       | No. Teeth | Diameter |       | No. Teeth | Diameter |        | No. Teeth | Diameter |        | No. Teeth | Diameter |        |
|-----------|----------|-------|-----------|----------|-------|-----------|----------|--------|-----------|----------|--------|-----------|----------|--------|
|           | P.D.     | O.D.  |           | P.D.     | O.D.  |           | P.D.     | O.D.   |           | P.D.     | O.D.   |           | P.D.     | O.D.   |
| 15H       | 2.387    | 2.333 | 35H       | 5.570    | 5.516 | 55H       | 8.754    | 8.700  | 75H       | 11.937   | 11.883 | 95H       | 15.120   | 15.066 |
| 16H       | 2.546    | 2.492 | 36H       | 5.730    | 5.676 | 56H       | 8.913    | 8.859  | 76H       | 12.096   | 12.042 | 96H       | 15.225   | 15.171 |
| 17H       | 2.706    | 2.652 | 37H       | 5.889    | 5.835 | 57H       | 9.072    | 9.018  | 77H       | 12.255   | 12.201 | 97H       | 15.438   | 15.384 |
| 18H       | 2.865    | 2.811 | 38H       | 6.048    | 5.994 | 58H       | 9.231    | 9.177  | 78H       | 12.414   | 12.360 | 98H       | 15.597   | 15.543 |
| 19H       | 3.024    | 2.970 | 39H       | 6.207    | 6.153 | 59H       | 9.390    | 9.336  | 79H       | 12.573   | 12.519 | 99H       | 15.756   | 15.702 |
| 20H       | 3.183    | 3.129 | 40H       | 6.366    | 6.312 | 60H       | 9.549    | 9.495  | 80H       | 12.732   | 12.678 | 100H      | 15.915   | 15.861 |
| 21H       | 3.342    | 3.288 | 41H       | 6.525    | 6.471 | 61H       | 9.708    | 9.654  | 81H       | 12.892   | 12.838 | 102H      | 16.234   | 16.180 |
| 22H       | 3.501    | 3.447 | 42H       | 6.685    | 6.631 | 62H       | 9.868    | 9.814  | 82H       | 13.051   | 12.997 | 104H      | 16.552   | 16.498 |
| 23H       | 3.661    | 3.607 | 43H       | 6.844    | 6.790 | 63H       | 10.027   | 9.973  | 83H       | 13.210   | 13.156 | 106H      | 16.870   | 16.816 |
| 24H       | 3.820    | 3.766 | 44H       | 7.003    | 6.949 | 64H       | 10.186   | 10.132 | 84H       | 13.369   | 13.315 | 108H      | 17.189   | 17.135 |
| 25H       | 3.979    | 3.925 | 45H       | 7.162    | 7.108 | 65H       | 10.345   | 10.291 | 85H       | 13.528   | 13.474 | 110H      | 17.507   | 17.453 |
| 26H       | 4.138    | 4.084 | 46H       | 7.321    | 7.267 | 66H       | 10.504   | 10.450 | 86H       | 13.687   | 13.633 | 115H      | 18.303   | 18.249 |
| 27H       | 4.297    | 4.243 | 47H       | 7.480    | 7.426 | 67H       | 10.663   | 10.609 | 87H       | 13.846   | 13.792 | 120H      | 19.099   | 19.045 |
| 28H       | 4.456    | 4.402 | 48H       | 7.639    | 7.585 | 68H       | 10.823   | 10.769 | 88H       | 14.005   | 13.952 | 125H      | 19.894   | 19.840 |
| 29H       | 4.615    | 4.561 | 49H       | 7.799    | 7.745 | 69H       | 10.982   | 10.928 | 89H       | 14.165   | 14.111 | 130H      | 20.690   | 20.636 |
| 30H       | 4.775    | 4.721 | 50H       | 7.958    | 7.904 | 70H       | 11.141   | 11.087 | 90H       | 14.324   | 14.270 | 135H      | 21.486   | 21.432 |
| 31H       | 4.934    | 4.880 | 51H       | 8.117    | 8.063 | 71H       | 11.300   | 11.246 | 91H       | 14.483   | 14.429 | 140H      | 22.282   | 22.228 |
| 32H       | 5.093    | 5.039 | 52H       | 8.276    | 8.222 | 72H       | 11.459   | 11.405 | 92H       | 14.642   | 14.588 | 145H      | 23.077   | 23.023 |
| 33H       | 5.252    | 5.198 | 53H       | 8.435    | 8.381 | 73H       | 11.618   | 11.564 | 93H       | 14.801   | 14.747 | 150H      | 23.873   | 23.819 |
| 34H       | 5.411    | 5.357 | 54H       | 8.594    | 8.540 | 74H       | 11.777   | 11.723 | 94H       | 14.961   | 14.907 | 156H      | 24.828   | 24.774 |

## XH - 7/8" Pitch

| No. Teeth | Diameter |        | No. Teeth | Diameter |        | No. Teeth | Diameter |        | No. Teeth | Diameter |        | No. Teeth | Diameter |        |
|-----------|----------|--------|-----------|----------|--------|-----------|----------|--------|-----------|----------|--------|-----------|----------|--------|
|           | P.D.     | O.D.   |           | P.D.     | O.D.   |           | P.D.     | O.D.   |           | P.D.     | O.D.   |           | P.D.     | O.D.   |
| 18XH      | 5.013    | 4.903  | 45XH      | 12.533   | 12.423 | 70XH      | 19.496   | 19.386 | 95XH      | 26.460   | 26.350 | 120XH     | 33.423   | 33.313 |
| 20XH      | 5.570    | 5.460  | 46XH      | 12.812   | 12.702 | 71XH      | 19.776   | 19.666 | 96XH      | 26.738   | 26.628 | 122XH     | 33.980   | 33.870 |
| 22XH      | 6.127    | 6.017  | 47XH      | 13.091   | 12.981 | 72XH      | 20.054   | 19.944 | 97XH      | 27.017   | 26.907 | 124XH     | 34.537   | 34.427 |
| 23XH      | 6.406    | 6.296  | 48XH      | 13.369   | 13.259 | 73XH      | 20.332   | 20.222 | 98XH      | 27.295   | 27.185 | 126XH     | 35.094   | 34.984 |
| 24XH      | 6.685    | 6.575  | 49XH      | 13.648   | 13.538 | 74XH      | 20.611   | 20.501 | 99XH      | 27.574   | 27.464 | 128XH     | 35.651   | 35.541 |
| 25XH      | 6.963    | 6.853  | 50XH      | 13.926   | 13.816 | 75XH      | 20.889   | 20.779 | 100XH     | 27.852   | 27.742 | 130XH     | 36.208   | 36.098 |
| 26XH      | 7.242    | 7.132  | 51XH      | 14.205   | 14.095 | 76XH      | 21.168   | 21.058 | 101XH     | 28.131   | 28.021 | 132XH     | 36.765   | 36.655 |
| 27XH      | 7.520    | 7.410  | 52XH      | 14.483   | 14.373 | 77XH      | 21.446   | 21.336 | 102XH     | 28.409   | 28.299 | 134XH     | 37.322   | 37.212 |
| 28XH      | 7.799    | 7.689  | 53XH      | 14.762   | 14.652 | 78XH      | 21.725   | 21.615 | 103XH     | 28.688   | 28.578 | 136XH     | 37.879   | 37.769 |
| 29XH      | 8.077    | 7.967  | 54XH      | 15.140   | 14.930 | 79XH      | 21.003   | 21.893 | 104XH     | 28.966   | 28.856 | 138XH     | 38.436   | 38.326 |
| 30XH      | 8.356    | 8.246  | 55XH      | 15.319   | 15.209 | 80XH      | 22.282   | 22.172 | 105XH     | 29.245   | 29.135 | 140XH     | 38.993   | 38.883 |
| 31XH      | 8.634    | 8.524  | 56XH      | 15.597   | 15.487 | 81XH      | 22.560   | 22.450 | 106XH     | 29.523   | 29.413 | 142XH     | 39.550   | 39.440 |
| 32XH      | 8.913    | 8.803  | 57XH      | 15.876   | 15.766 | 82XH      | 22.839   | 22.729 | 107XH     | 29.802   | 29.692 | 144XH     | 40.107   | 39.997 |
| 33XH      | 9.191    | 9.081  | 58XH      | 16.154   | 16.044 | 83XH      | 23.118   | 23.008 | 108XH     | 30.080   | 29.970 | 146XH     | 40.664   | 40.554 |
| 34XH      | 9.470    | 9.360  | 59XH      | 16.433   | 16.323 | 84XH      | 23.396   | 23.286 | 109XH     | 30.359   | 30.249 | 150XH     | 41.778   | 41.668 |
| 35XH      | 9.748    | 9.638  | 60XH      | 16.711   | 16.601 | 85XH      | 23.674   | 23.564 | 110XH     | 30.637   | 30.527 |           |          |        |
| 36XH      | 10.027   | 9.917  | 61XH      | 16.990   | 16.880 | 86XH      | 23.953   | 23.843 | 111XH     | 30.916   | 30.806 |           |          |        |
| 37XH      | 10.305   | 10.195 | 62XH      | 17.268   | 17.158 | 87XH      | 24.231   | 24.121 | 112XH     | 31.194   | 31.084 |           |          |        |
| 38XH      | 10.584   | 10.474 | 63XH      | 17.547   | 17.437 | 88XH      | 24.510   | 24.400 | 113XH     | 31.473   | 31.363 |           |          |        |
| 39XH      | 10.862   | 10.752 | 64XH      | 17.825   | 17.715 | 89XH      | 24.788   | 24.678 | 114XH     | 31.751   | 31.641 |           |          |        |
| 40XH      | 11.141   | 11.031 | 65XH      | 18.104   | 17.994 | 90XH      | 25.067   | 24.957 | 115XH     | 32.030   | 31.920 |           |          |        |
| 41XH      | 11.419   | 11.309 | 66XH      | 18.382   | 18.272 | 91XH      | 25.345   | 25.235 | 116XH     | 32.308   | 32.198 |           |          |        |
| 42XH      | 11.698   | 11.588 | 67XH      | 18.661   | 18.551 | 92XH      | 25.624   | 25.514 | 117XH     | 32.587   | 32.477 |           |          |        |
| 43XH      | 11.976   | 11.866 | 68XH      | 18.939   | 18.829 | 93XH      | 25.902   | 25.792 | 118XH     | 32.865   | 32.755 |           |          |        |
| 44XH      | 12.255   | 12.145 | 69XH      | 19.218   | 19.108 | 94XH      | 26.181   | 26.071 | 119XH     | 33.145   | 33.035 |           |          |        |

## Outside Diameter Tolerances

| PULLEY DIA. | O.D. TOL.        | PULLEY DIA. | O.D. TOL.        | PULLEY DIA.  | O.D. TOL.        | PULLEY DIA. | O.D. TOL.        |
|-------------|------------------|-------------|------------------|--------------|------------------|-------------|------------------|
| 0-1"        | +0.002<br>-0.000 | 2.001" -4"  | +0.004<br>-0.000 | 7.001" -12"  | +0.006<br>-0.000 | 20.001 UP   | +0.008<br>-0.000 |
| 1.000"-2"   | +0.003<br>-0.000 | 4.001" -7"  | +0.005<br>-0.000 | 12.001" -20" | +0.007<br>-0.000 |             |                  |